

Howard Building 1st Floor

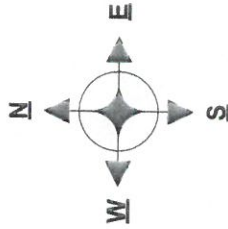

*PHASE 2
10/11/19
HARD OFC MOVE*

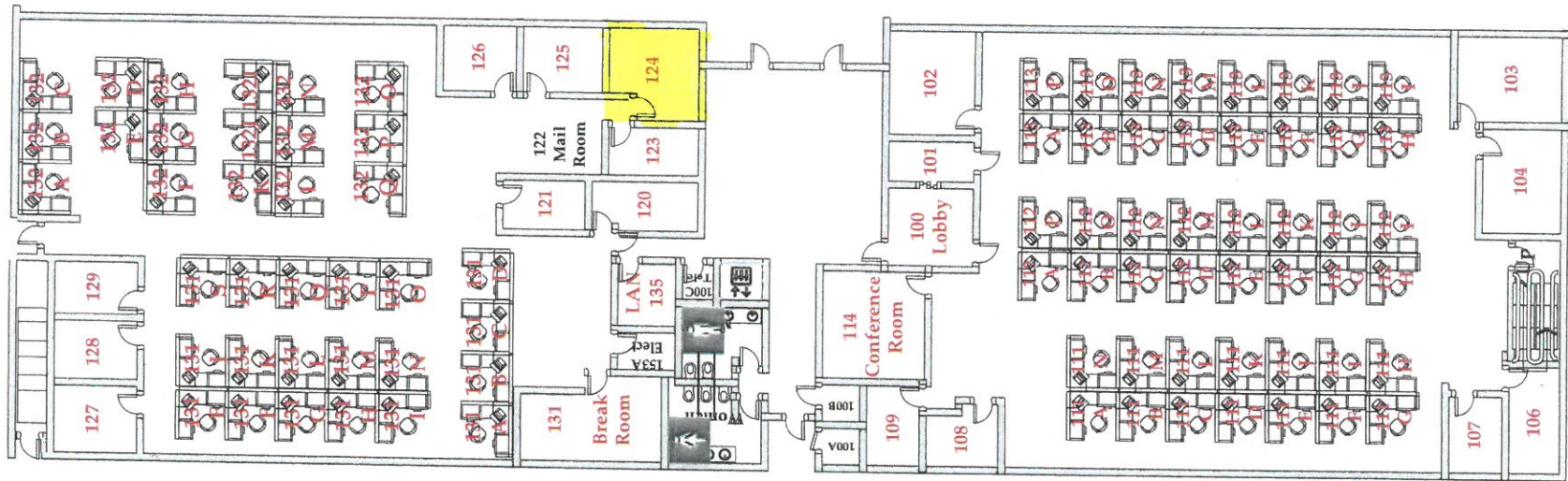
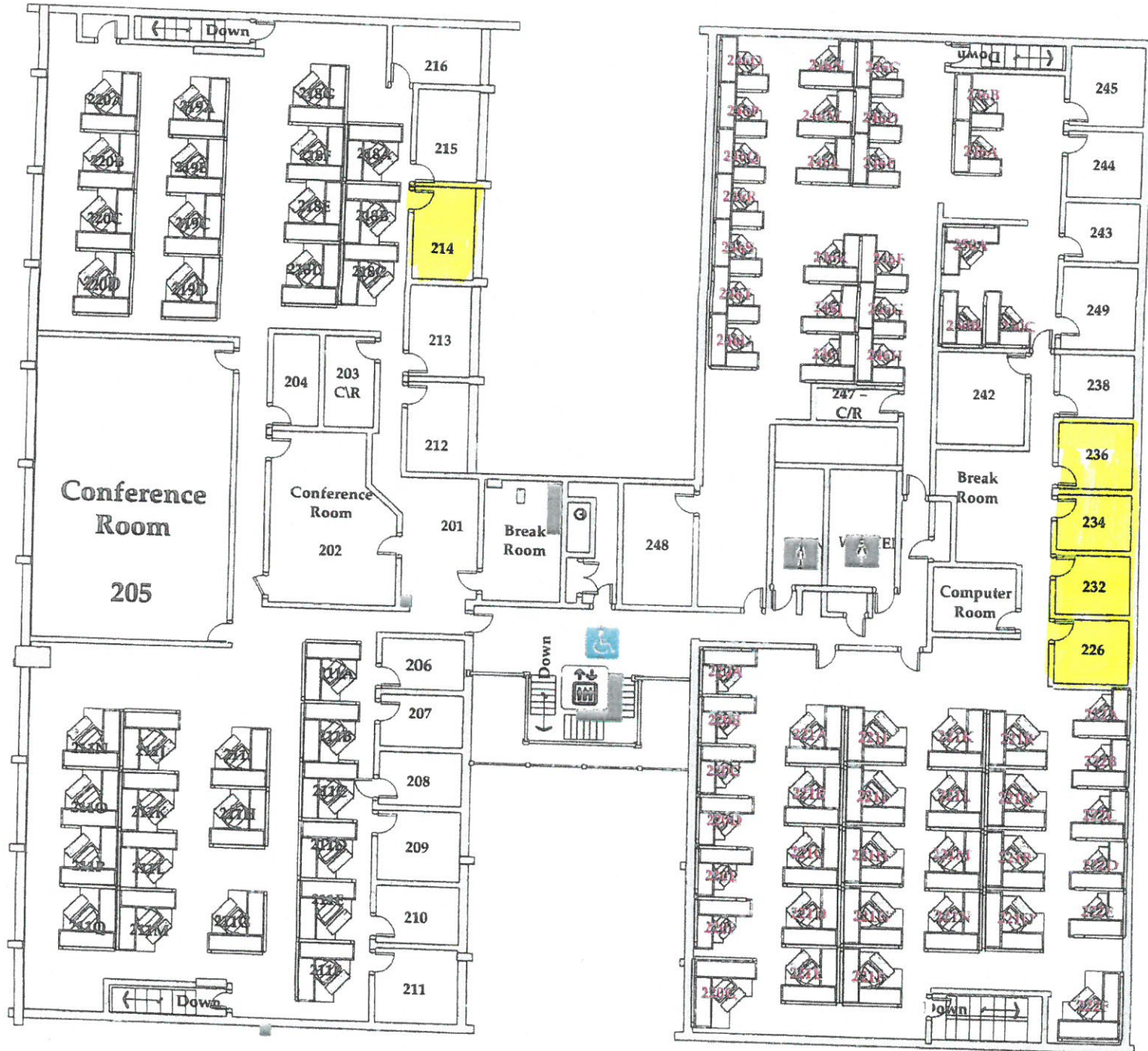
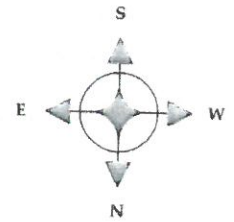

EXHIBIT 2
PHASE II



Lafayette
Building
2nd Floor

PHASE 2
10/11/19
HARD OFC
MOVES



1st Floor Turner Bldg v13 -- Central Area 2

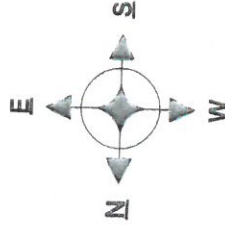

PHASE 2

10/11/19

HARD OF MOVE

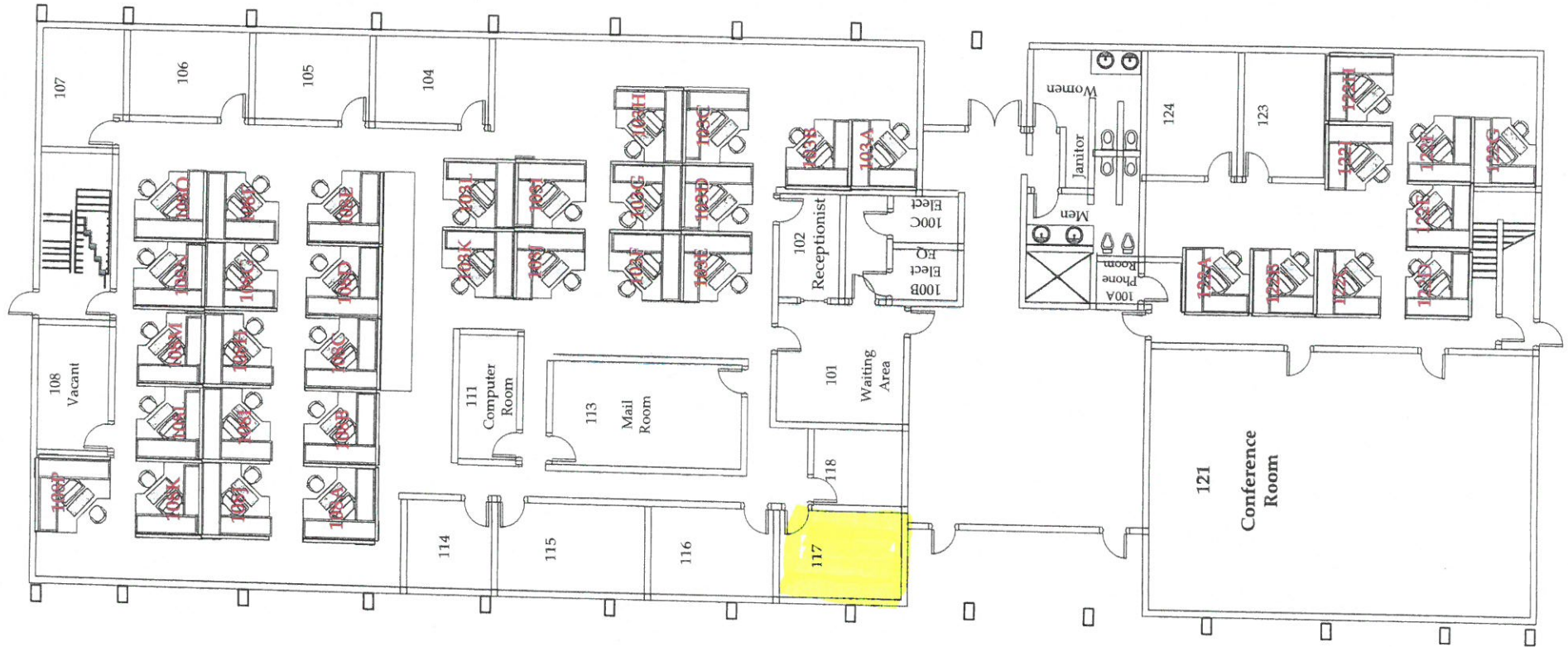

Turner Building 2nd Floor

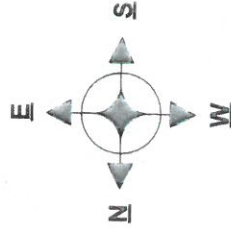

*PHASE 2
10/11/19
AHEAD OF MOVES*

