

**COMPONENTS OF CONTRACT PLANS SET**

- CIVIL & LANDSCAPE PLANS
- ARCHITECTURAL BUILDING PLANS
- STRUCTURAL BUILDING PLANS
- MECHANICAL PLANS
- ELECTRICAL/LIGHTING PLANS
- PLUMBING PLANS
- SIGNAGE & PAVEMENT PLANS

SEE SHEET AG-101 FOR FULL DRAWING INDEX

**STATE OF FLORIDA  
DEPARTMENT OF TRANSPORTATION**

**CONTRACT PLANS**

FINANCIAL PROJECT ID 433874-1-52-01

**OSCEOLA COUNTY (92)**

**MULTI-MODAL TRANSPORTATION FACILITY  
(PARKING GARAGE)**

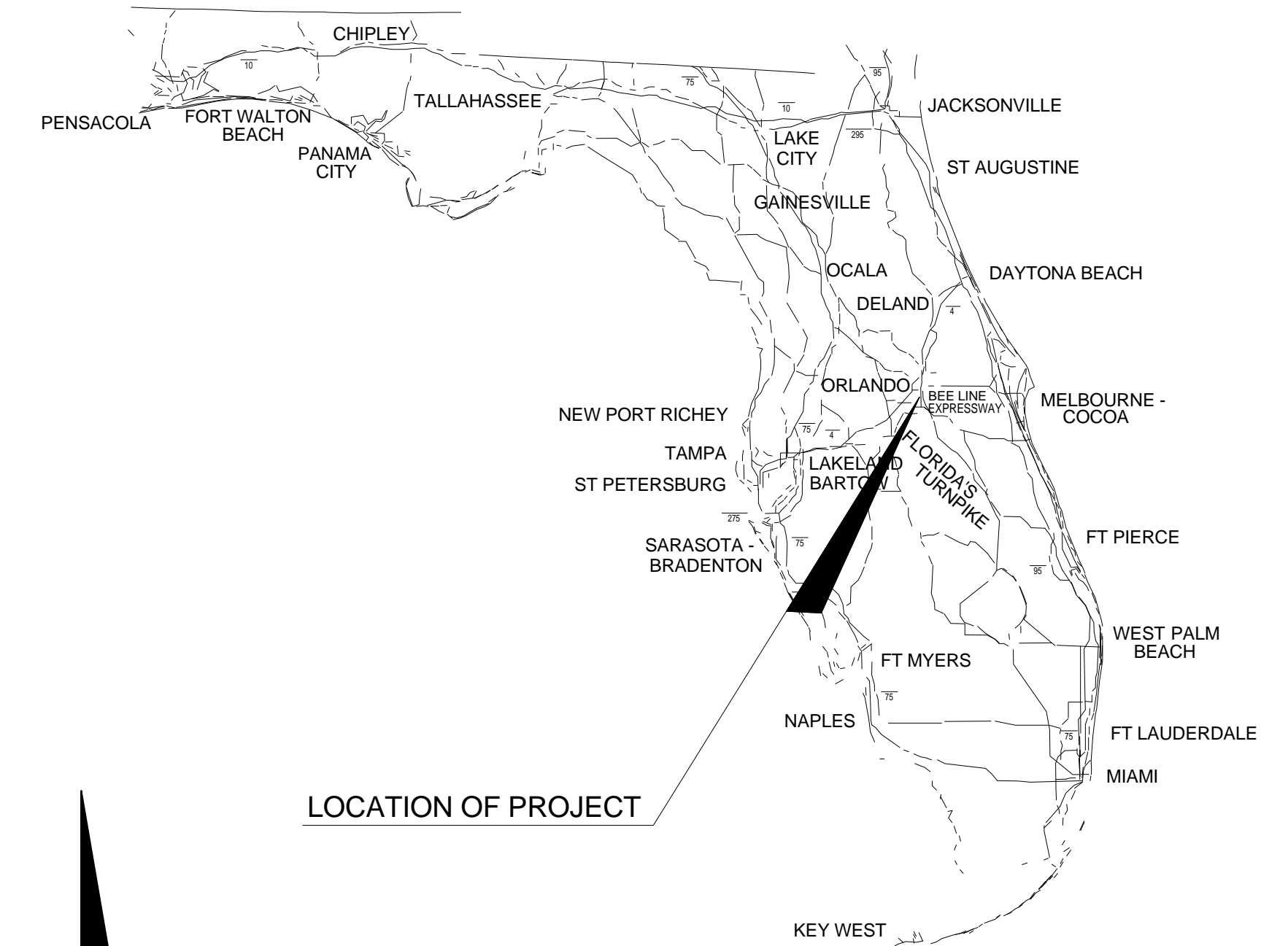

LOCATION OF PROJECT

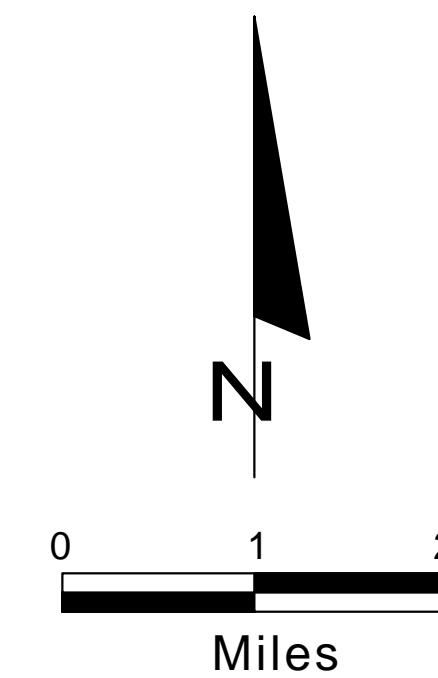
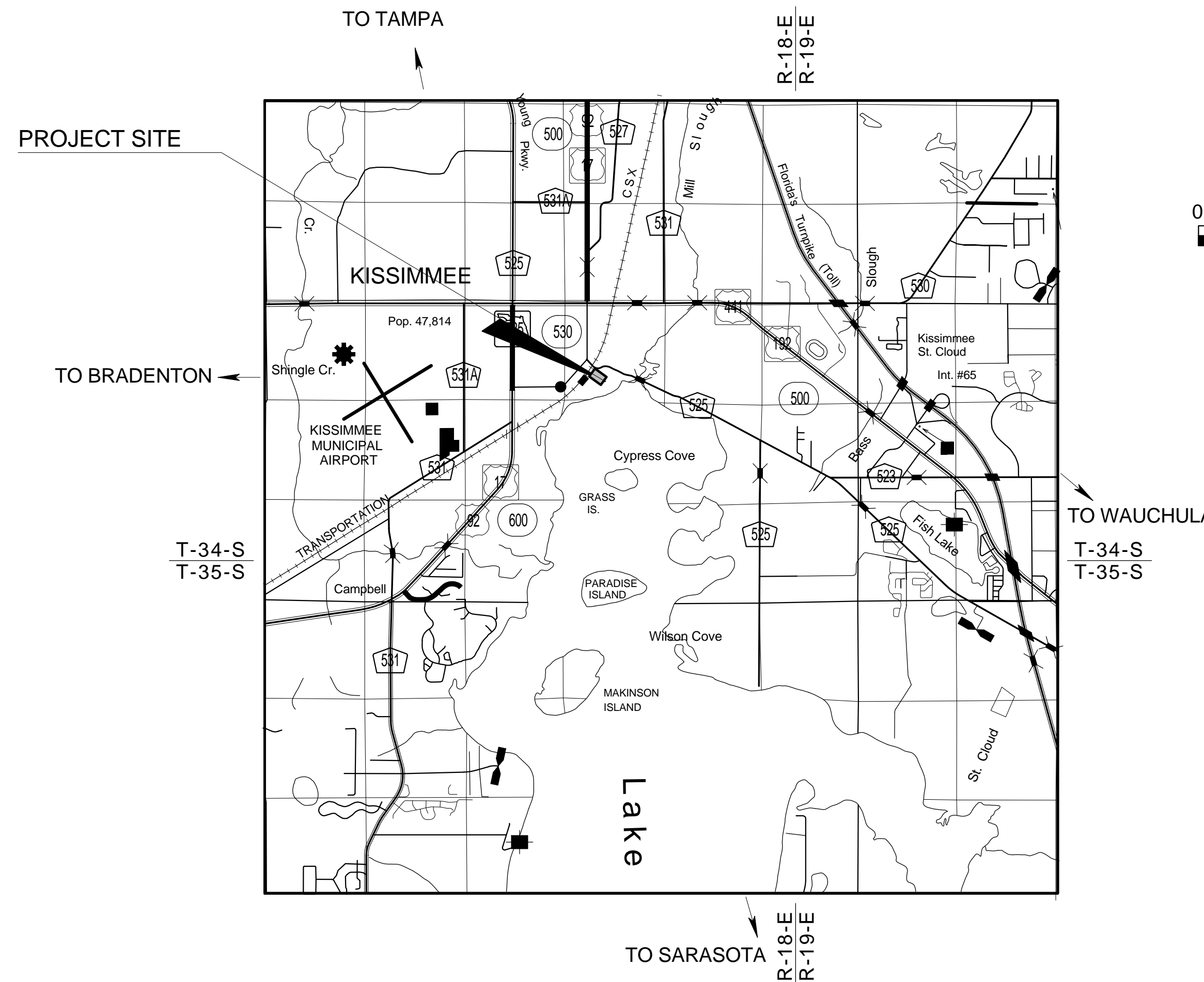

BUILDING SHOP DRAWINGS  
TO BE SUBMITTED TO:

TRANSYSTEMS  
4500 SALISBURY ROAD, SUITE 440  
JACKSONVILLE, FL 32216

PLANS PREPARED BY:

TRANSYSTEMS  
4500 SALISBURY ROAD, SUITE 440  
JACKSONVILLE, FL 32216

CERTIFICATE OF AUTHORIZATION No: 7503  
ARCHITECT BUSINESS No: AA3384

NOTE: THE SCALE OF THESE PLANS MAY  
HAVE CHANGED DUE TO REPRODUCTION.

NOTE: THE CONTRACTOR SHOULD NOT ENCROACH WITHIN THE RAILROAD R/W DURING ANY CONSTRUCTION OPERATIONS. IF ENCROACHMENT OR THE POTENTIAL TO FOUL THE TRACKS IS UNAVOIDABLE, THE CONTRACTOR SHALL COORDINATE WITH THE CFRC OR THE SUNRAIL CONTRACTORS. THE CONTRACTOR MUST ADHERE TO ALL RAILROAD SAFETY PROCEDURES WHEN ENCROACHING WITHIN THE RAILROAD R/W OR HAVING THE POTENTIAL TO FOUL THE TRACKS.

**GOVERNING STANDARDS AND SPECIFICATIONS:**  
Florida Department of Transportation, 2015 Design Standards and revised Index Drawings as appended herein, and July 2015 Standard Specifications for Road and Bridge Construction, as amended by Contract Documents.

For Design Standards click on the "Design Standards" link at the following web site:  
<http://www.dot.state.fl.us/rddesign/>

**REVISIONS:**

Drawing Sheets: AS-503, AA-601, AA-701, AA-705, AE-100, AE-101, AE-200, AE-201, AE-204, AE-501 (Revised 8-3-2015)

KEY SHEET REVISIONS	
DATE	DESCRIPTION
8-3-2015	Added list of Revised Drawings for Addendum No. 1.

BUILDING PLANS  
ARCHITECT OF RECORD: TODD ERIC DUNAVANT, AIA

ARCH. REG. NO.: 16238

FISCAL YEAR	SHEET NO.
16	AG-001

FDOT PROJECT MANAGER: KEVIN MOSS

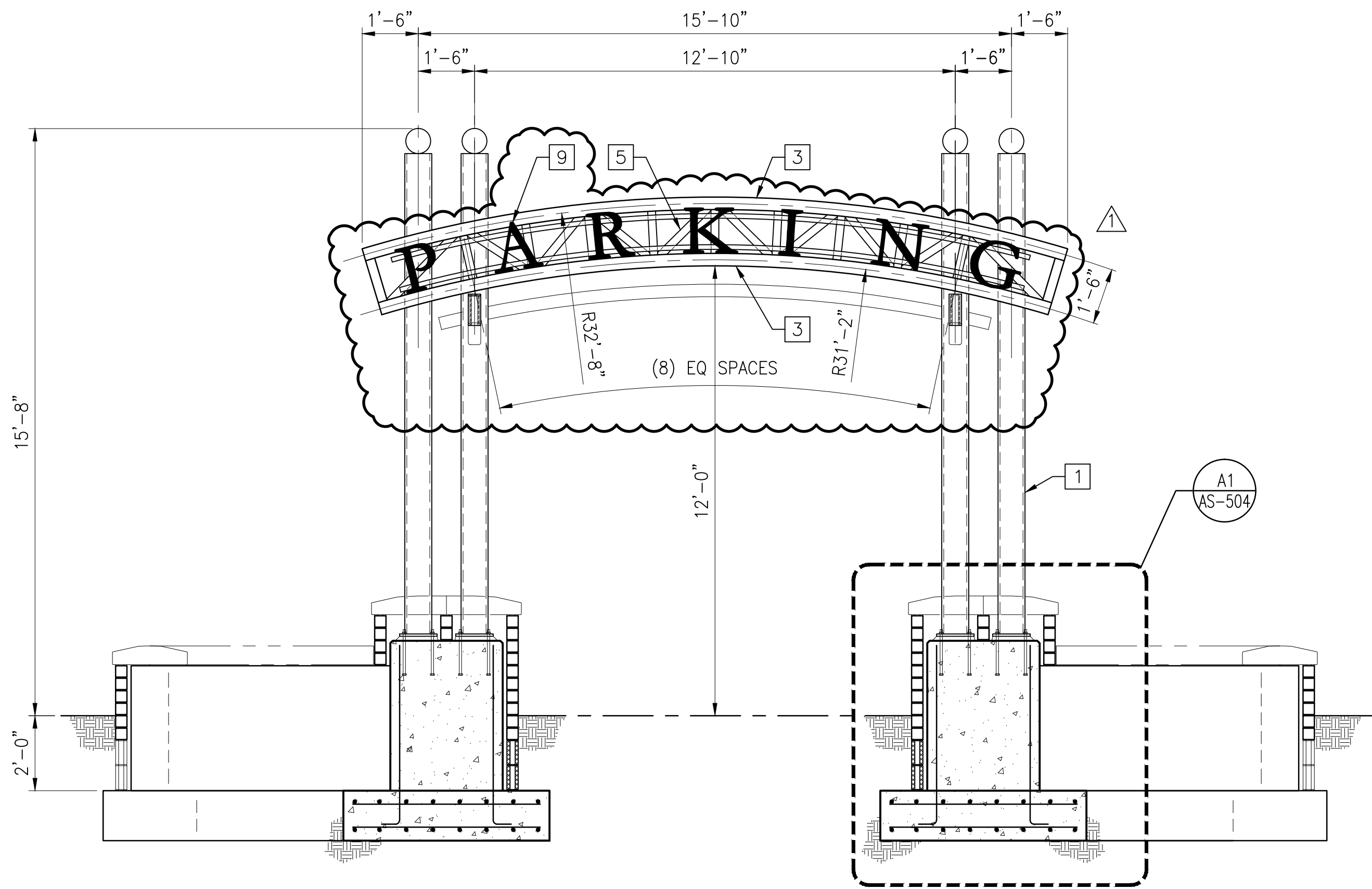

**B2** ELEVATION - WEST ENTRANCE ARCHES  
SCALE: 3/8"=1'-0"

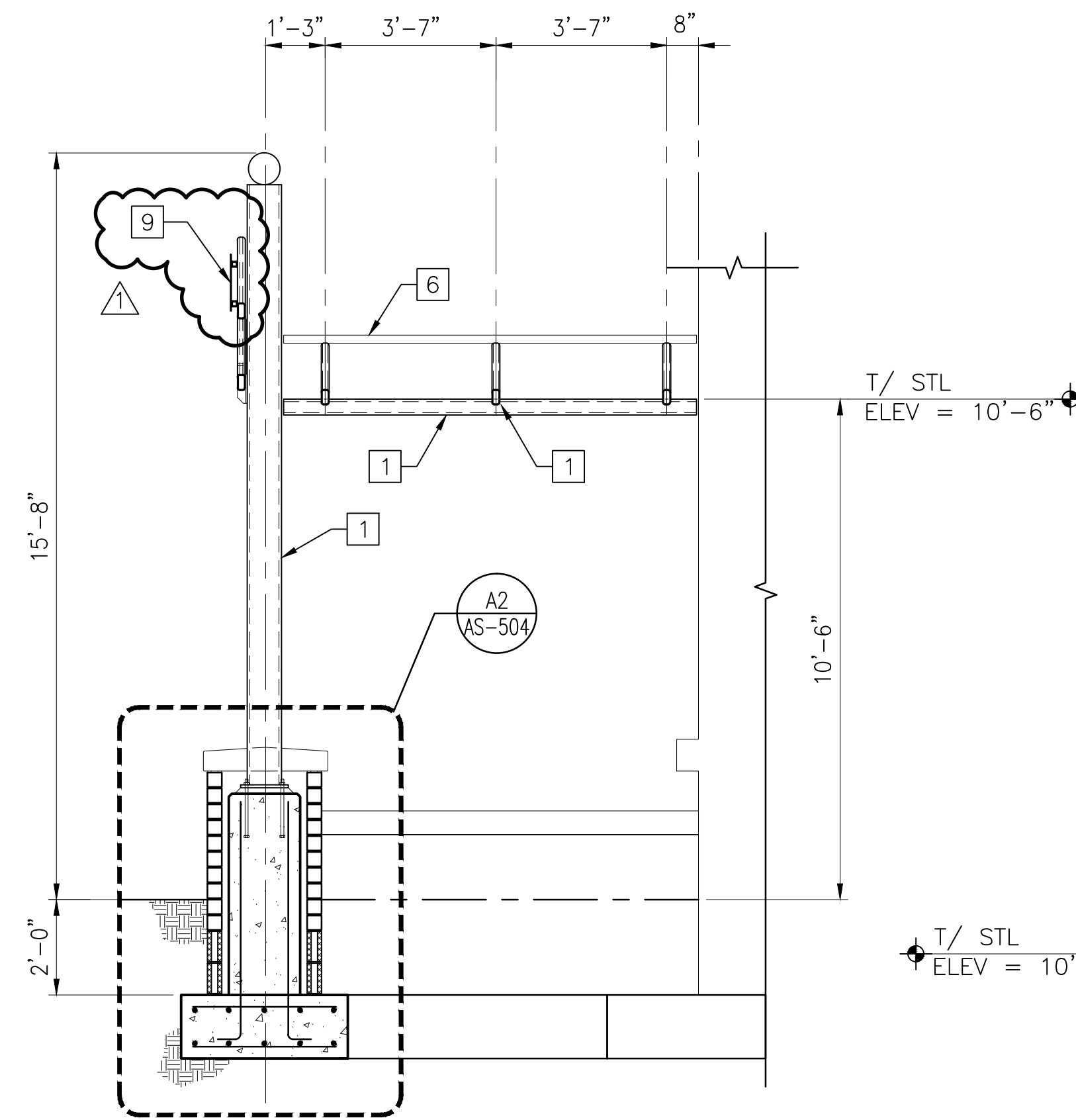

**B3** ELEVATION - WEST ENTRANCE ARCHES  
SCALE: 3/8"=1'-0"

**PLAN NOTES:**

- ALL STRUCTURAL STEEL EXPOSED TO THE PUBLIC VIEW SHALL BE PART OF THE ARCHITECTURAL EXPOSED STRUCTURAL SYSTEM IN ACCORDANCE WITH THE PROJECT SPECIFICATIONS.

**KEYED NOTES:**

- HSS8.625x.322 POST, (4) REQUIRED AT EACH ARCH ON WEST SIDE OF GARAGE, (8) TOTAL.
- HSS10x.312, (4) REQUIRED FOR ARCH ON SOUTH SIDE OF GARAGE.
- HSS4x2x1/4 CURVED TOP AND BOTTOM CHORDS.
- HSS6x6x3/8 CURVED TOP AND BOTTOM CHORDS.
- HSS2 1/2 x 2 1/2 x 3/16
- HSS2x2x3/16 PURLINS, EQUALLY SPACED.
- HSS6x4x3/16 BEAM
- HSS4x2x5/16 ARCHED RAFTERS
- 1'-4" x 1/4" ALUM. DIMENSIONAL LETTER SIGNAGE MOUNTED TO ARCH. SEE SPEC SECTION 101419. PROVIDE MOUNTING BRACKETS AND STAINLESS STEEL HARDWARE AS REQUIRED. COORDINATE ATTACHMENT TO TRUSS W/ TRUSS MANUFACTURER.

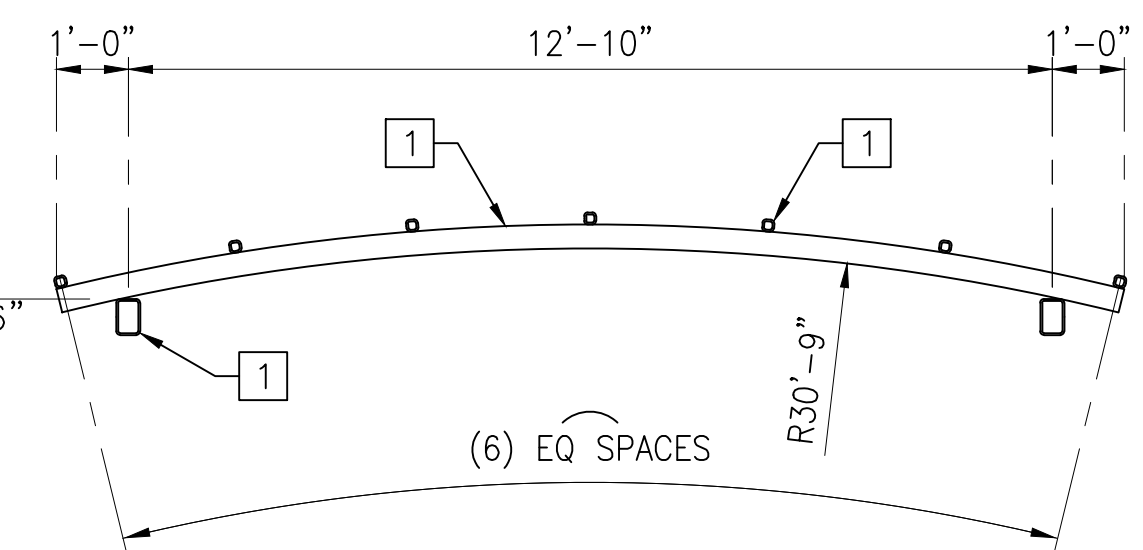

**B4** ELEVATION - WEST ENTRANCE ARCHES  
SCALE: 3/8"=1'-0"

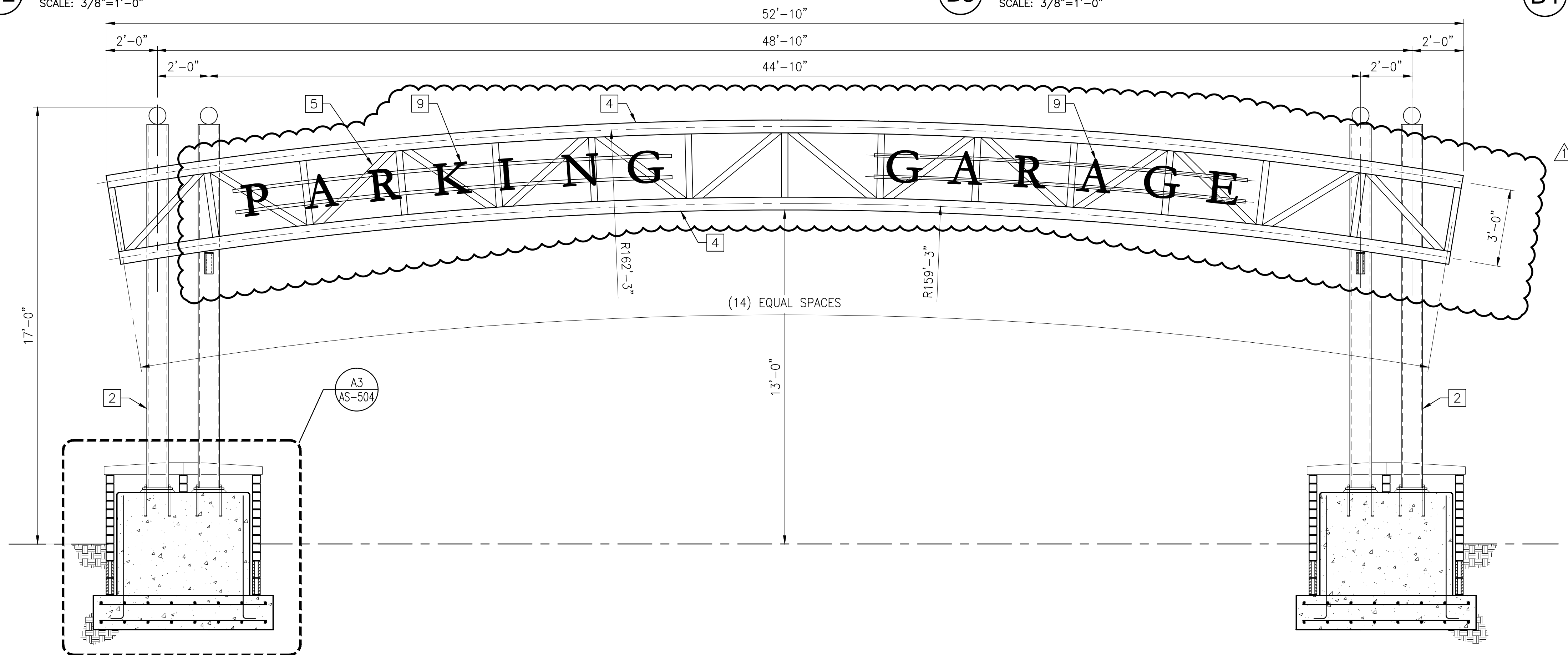

**A2** ELEVATION - SOUTHEAST ENTRANCE ARCH  
SCALE: 3/8"=1'-0"

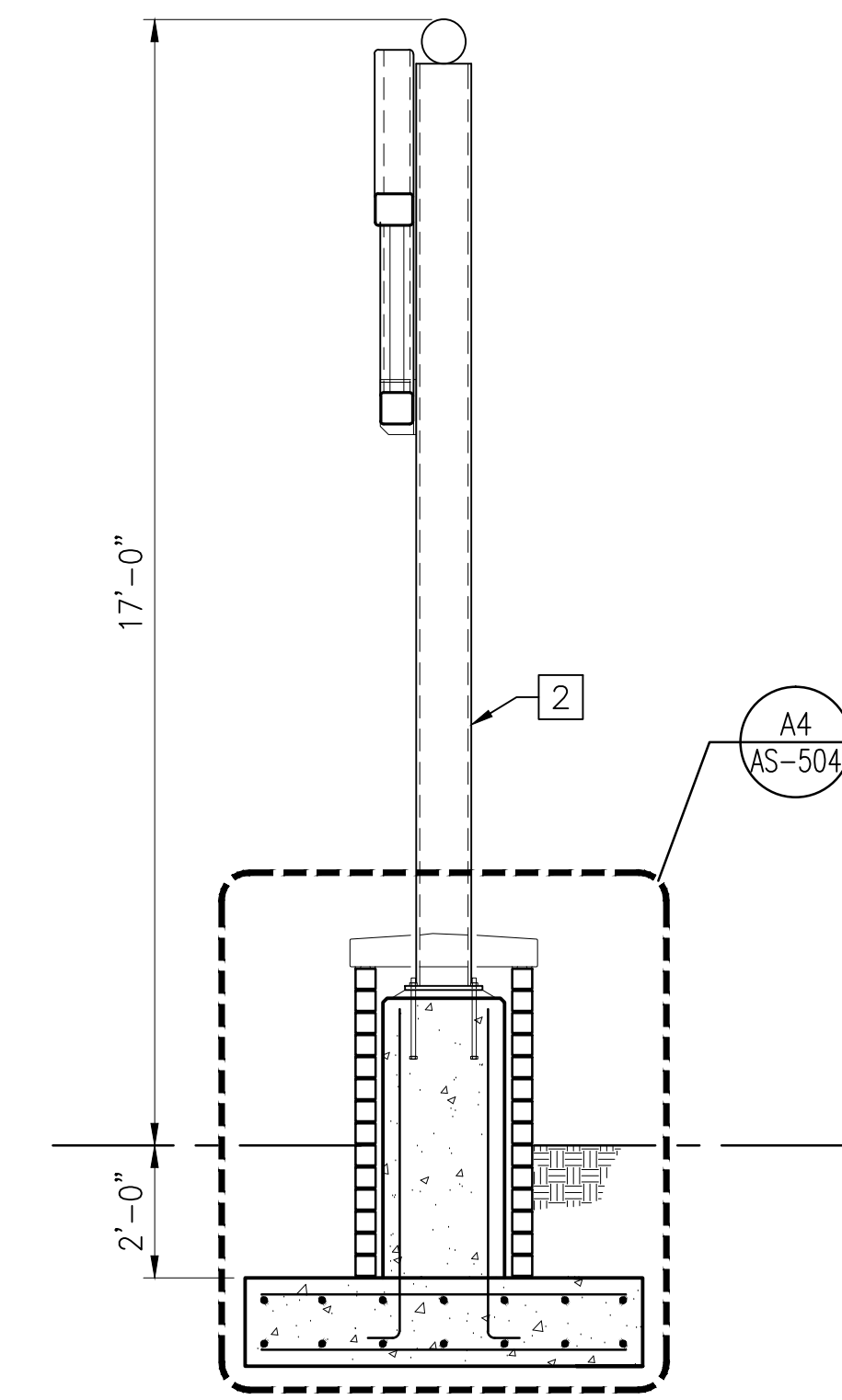

**A2** ELEVATION - SOUTHEAST ENTRANCE ARCH  
SCALE: 3/8"=1'-0"

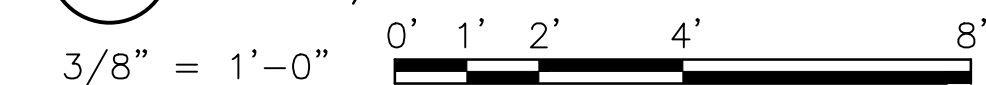

4600 SALISBURY ROAD  
SUITE 440  
JACKSONVILLE, FLORIDA 32216  
PHONE: 904-245-6500  
FAX: 904-245-6510

MULTI-MODAL TRANSPORTATION FACILITY  
(PARKING GARAGE)  
CITY OF KISSIMMEE, FLORIDA

FDOT DISTRICT FIVE  
OSCEOLA COUNTY  
FOOT FINANCIAL ID. NO. 4339741-52-01

REVISIONS:	MARK	DATE	DESCRIPTION
	A	08/03/2015	BIDDING ADDENDUM 01

DRC NO:  
SCALE: AS NOTED  
DATE:  
DESIGNED BY: AB  
DRAWN BY: MAC  
CHECKED BY: KLT

SHEET TITLE:  
**ENTRANCE ARCH ELEVATIONS AND SECTIONS**

SHEET NO.  
**AS-503**

SHEET X OF XX

FILE NAME: C:\tran\systems\proj\local\tran\scorp-pw1\tran\scorp-pw1\as-503.dwg LAYOUT NAME: AS-503 PLOTTED: Monday, August 03, 2015 - 2:41pm USER: machappell

## DOOR SCHEDULE

DOOR NUMBER	PAIR	DOOR ELEVATION	DOOR SIZE		DOOR MATERIAL	DOOR FRAME		DETAILS			FIRE RATING	HARDWARE SETS	REMARKS
			WIDTH	HEIGHT		MATERIAL	ELEVATION	HEAD	JAMB	THRESHOLD			
101		A	3'-8"	7'-0"	H.M.	H.M.	F1	3/AA-602	2/AA-602	1/AA-602	-	H1	
101A		NOTE	15'-6"	10'-0"	STL.	STL.	-	9/AA-602	8/AA-602	7/AA-602	-	-	NOTE 3
101B		NOTE	15'-6"	10'-0"	STL.	STL.	-	9/AA-602	8/AA-602	7/AA-602	-	-	NOTE 3
102	PR.	A	3'-0"	7'-0"	H.M.	H.M.	F2	6/AA-602	5/AA-602	4/AA-602	C	H2	FIRE RATED
103A		A	3'-0"	7'-0"	H.M.	H.M.	F2	6/AA-602	5/AA-602	4/AA-602	-	H3	INSULATED
103B		A	4'-0"	7'-0"	H.M.	H.M.	F2	6/AA-602	5/AA-602	4/AA-602	C	H2A	FIRE RATED, INSULATED
104		A	3'-0"	7'-0"	H.M.	H.M.	F1	3/AA-602	2/AA-602	1/AA-602 SIM.	-	H3	INSULATED
105		A	3'-0"	7'-0"	H.M.	H.M.	F1	3/AA-602	2/AA-602	1/AA-602 SIM.	-	H3	
106		A	3'-0"	7'-0"	H.M.	H.M.	F1	3/AA-602	2/AA-602	1/AA-602 SIM.	-	H3	
107		A	3'-0"	7'-0"	H.M.	H.M.	F1	3/AA-602	2/AA-602	1/AA-602 SIM.	-	H3A	
202		A	3'-0"	7'-0"	H.M.	H.M.	F2	6/AA-602	5/AA-602	4/AA-602	-	H3	
203		A	3'-0"	7'-0"	H.M.	H.M.	F2	6/AA-602	5/AA-602	4/AA-602	-	H3	
204		A	3'-0"	7'-0"	H.M.	H.M.	F1	3/AA-602	2/AA-602	1/AA-602 SIM.	-	H3	
205		A	3'-0"	7'-0"	H.M.	H.M.	F1	3/AA-602	2/AA-603	1/AA-602	-	H3	
302		A	3'-0"	7'-0"	H.M.	H.M.	F2	6/AA-602	5/AA-602	4/AA-602	-	H3	
303		A	3'-0"	7'-0"	H.M.	H.M.	F2	6/AA-602	5/AA-602	4/AA-602	-	H3	
304		A	3'-0"	7'-0"	H.M.	H.M.	F1	3/AA-602	2/AA-602	1/AA-602 SIM.	-	H3	
305		A	3'-0"	7'-0"	H.M.	H.M.	F1	3/AA-603	2/AA-602	1/AA-602	-	H3A	
402		A	3'-0"	7'-0"	H.M.	H.M.	F2	6/AA-602	5/AA-602	4/AA-602	-	H3	
403		A	3'-0"	7'-0"	H.M.	H.M.	F1	3/AA-602	2/AA-602	1/AA-602 SIM.	-	H3	
404		A	3'-0"	7'-0"	H.M.	H.M.	F1	3/AA-602	2/AA-602	1/AA-602 SIM.	-	H3A	
S1		A	3'-8"	7'-0"	H.M.	H.M.	F1	3/AA-602	2/AA-602	1/AA-602	-	H1	
S2	PR.	B	3'-0"	7'-0"	ALUM.	ALUM.	-	3/AA-603	2/AA-603	1/AA-603	-	H4	NOTE 2
S3	PR.	B	3'-0"	7'-0"	ALUM.	ALUM.	-	3/AA-603	2/AA-603	1/AA-603	-	H4	NOTE 2

**DOOR AND FRAME NOTES:**

- ALL DOOR SHALL BE 1 3/4" THICK UNLESS NOTED OTHERWISE.
- ALUMINUM DOORS TO HAVE 4" MINIMUM NOMINAL FRAME THICKNESS. DOORS TO HAVE MINIMUM 10" BOTTOM RAIL. HARDWARE TO BE PROVIDED BY ALUMINUM STOREFRONT MANUFACTURER.
- OVERHEAD COILING GRILLE.

**LEGEND:**

- ALUM. ALUMINUM  
H.M. HOLLOW METAL  
STL. STEEL (GALVANIZED)

## PAINT FINISH SCHEDULE

**NOTE 1:** In addition to the areas and items indicated to receive paint finish within the notes, drawings and specifications, provide paint finish at the locations listed below.

**NOTE 2:** The following locations do NOT require paint finish: Precast Lite wall (except as noted below), precast stairs, cast stone caps at planters and arched entry signage, underside of double tees, interior face of precast wall panels (except as noted below.)

LOCATION	REMARKS
Exterior face of precast panels.	Includes all non-brick portions of all exterior precast panels. Also includes cornice, medallions & decorative frame features around medallions.
Jamb, Head and Sill of window openings in the precast panels.	Provide accent color at reveal edge of window openings.
Jamb and Head of Door Openings	
Parapet: Top and backside (facing the parking areas) of parapet at Level 4	Including Lite Wall.
Exposed precast at Level 4.	
Exterior precast headers, sills, reveals, joints and trim.	
Non-brick portions of exterior pilasters and pilaster caps.	
Outward facing walls surrounding the elevator shaft on all levels.	Include full wall at elevator lobbies.
Concrete Masonry Unit walls and partitions.	All exposed sides, including head and jamb at openings.
All exposed steel.	
Hollow metal doors and frames.	

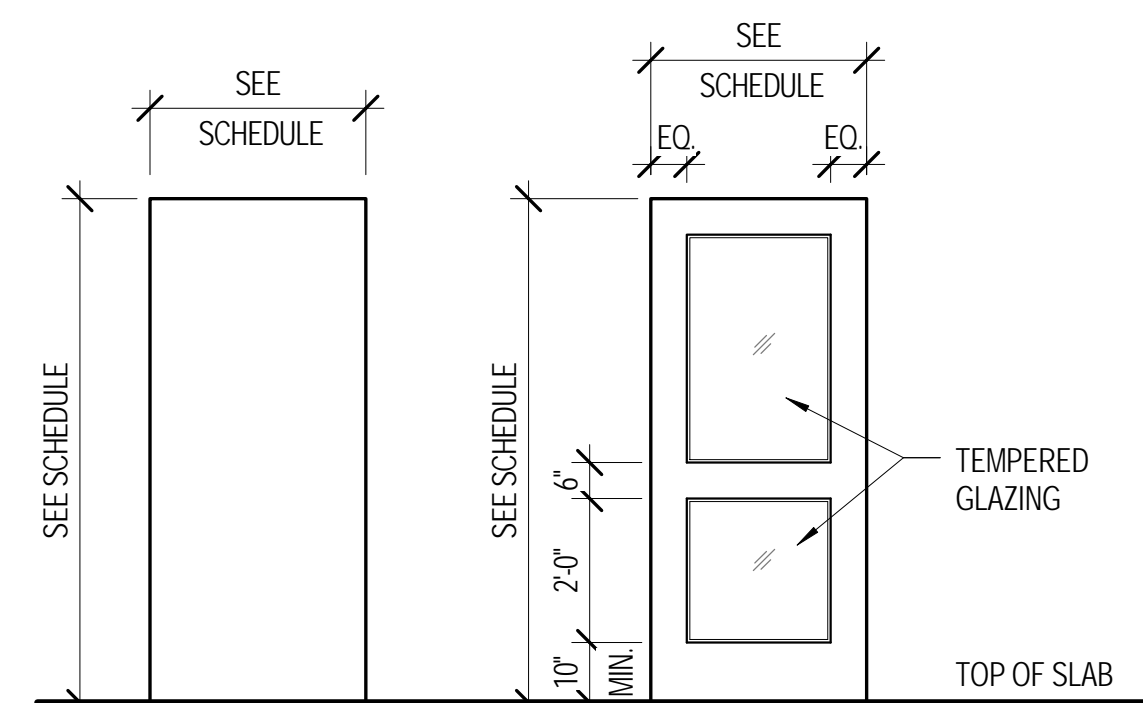

**A** FLUSH  
**B** ALUMINUM FULL GLASS MEDIUM OR WIDE STYLE

**DOOR ELEVATIONS**  
3/8" = 1'-0" 1

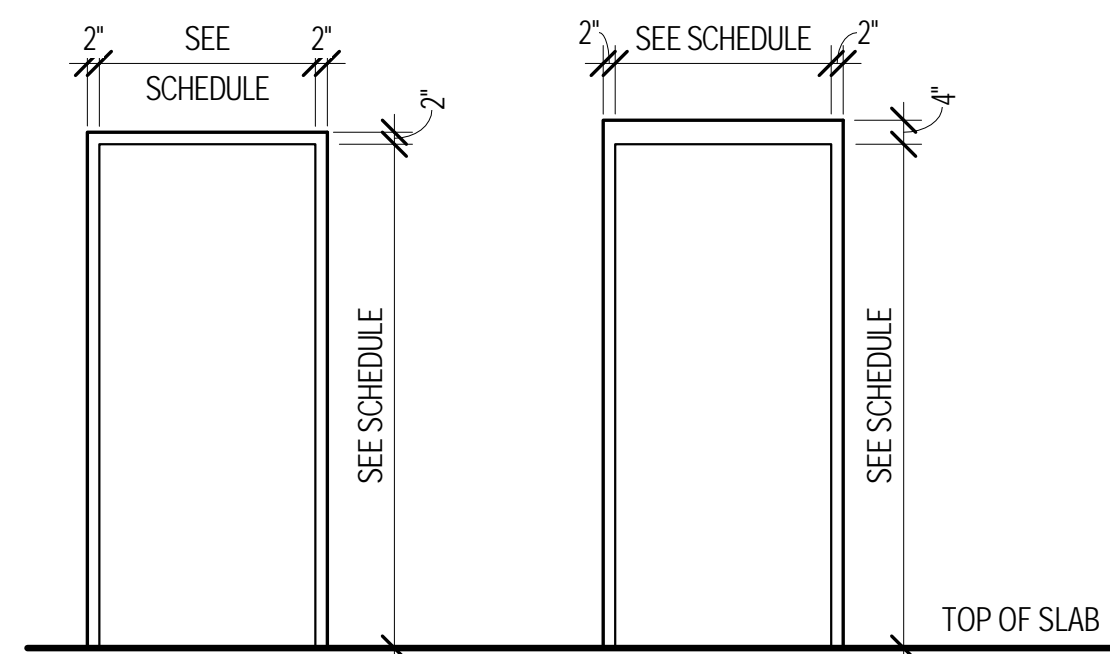

**F1** HOLLOW METAL (PAINT FINISH)  
**F2** HOLLOW METAL (PAINT FINISH)

**DOOR FRAME ELEVATIONS**  
3/8" = 1'-0" 2

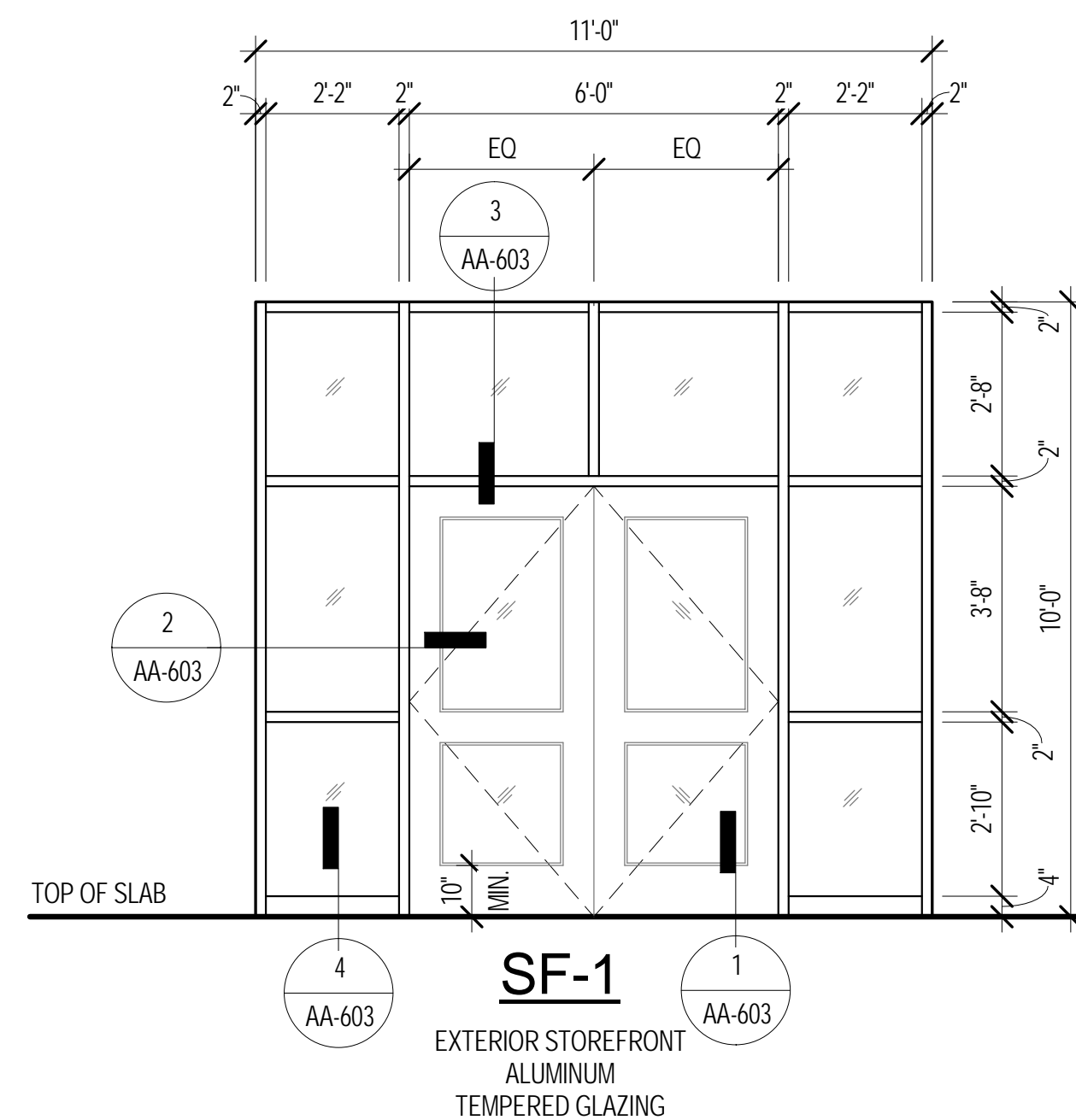

**SF-1** EXTERIOR STOREFRONT ALUMINUM TEMPERED GLAZING

**STOREFRONT ELEVATION**  
3/8" = 1'-0" 3

**GRAPHIC SCALE:**

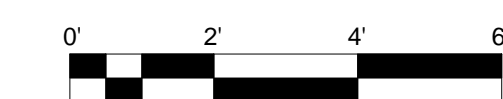

**Tran Systems**

4500 SALISBURY ROAD  
SUITE 440  
JACKSONVILLE, FLORIDA 32216  
TEL: 904-245-6800  
FAX: 904-245-6870



MULTI-MODAL TRANSPORTATION FACILITY  
(PARKING GARAGE)

CITY OF KISSIMMEE, FLORIDA

FOOT DISTRICT FIVE  
OSCEOLA COUNTY  
FOOT FINANCIAL ID NO. 483874-1-52-01

REVISIONS:	DATE	DESCRIPTION

DRC NO:  
SCALE: AS SHOWN  
DATE: MAY 15, 2015  
DESIGNED BY: TED  
DRAWN BY: MDB  
CHECKED BY: TED

**SHEET TITLE:**  
**DOOR SCHEDULE & ELEVATIONS**

SHEET NO.  
**AA-601**  
SHEET OF

8/3/2015 12:57:49 PM C:\Users\ledunavant\Documents\Revit Local Files\Kissimmee Garage - RVT2014 (Final)\_ledunavant.rvt

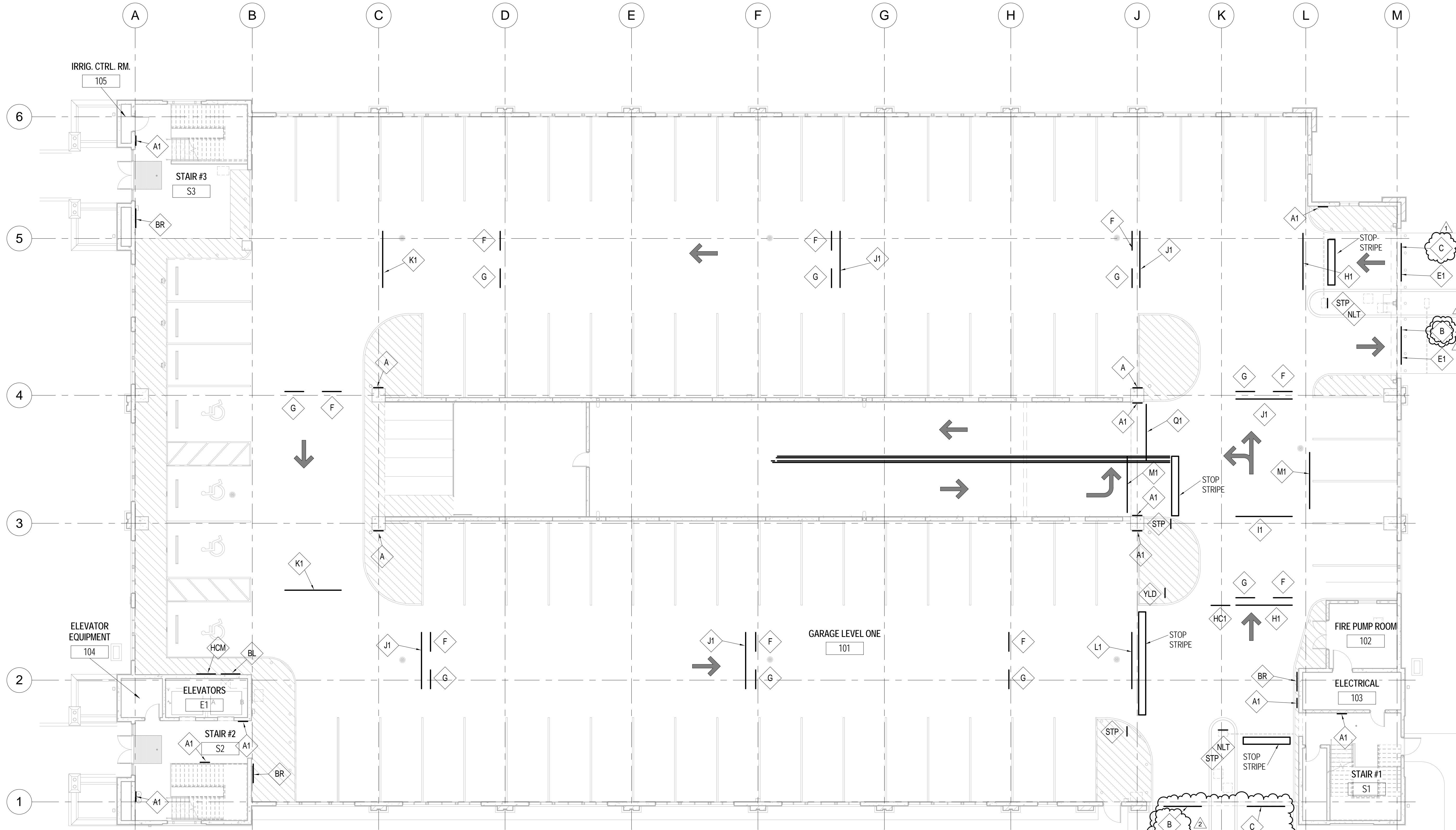

**COMPOSITE LEVEL ONE SIGNAGE PLAN**  
3/32" = 1'-0"

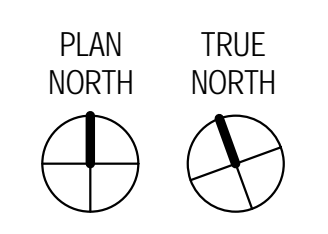

**SYMBOLS LEGEND**  
 C INDICATES SIGNAGE TYPE. SEE SHEETS AA-705 & AA-706 FOR DETAILS  
 — INDICATES SIGNAGE LOCATION.

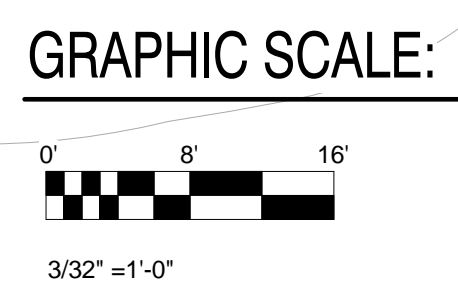

**TranSystems**  
 4500 SALISBURY ROAD  
 SUITE 440  
 JACKSONVILLE, FLORIDA 32216  
 P. 904-454-6800  
 FAX 904-454-6810



**MULTI-MODAL TRANSPORTATION FACILITY (PARKING GARAGE)**  
 CITY OF KISSIMMEE, FLORIDA  
 FOOT DISTRICT FIVE  
 OSCEOLA COUNTY  
 FOOT FINANCIAL ID NO. 483874-1-52-01

REVISIONS:	MARK	DATE	DESCRIPTION
	A	08/03/2015	BIDDING ADDENDUM 01
	B	05/15/2015	COK REVIEW COMMENTS

DRC NO:  
 SCALE: AS SHOWN  
 DATE: MAY 15, 2015  
 DESIGNED BY: TED  
 DRAWN BY: MDB  
 CHECKED BY: TED

**SHEET TITLE:**  
 COMPOSITE LEVEL ONE SIGNAGE PLAN

**SHEET NO.**  
 AA-701  
 SHEET OF

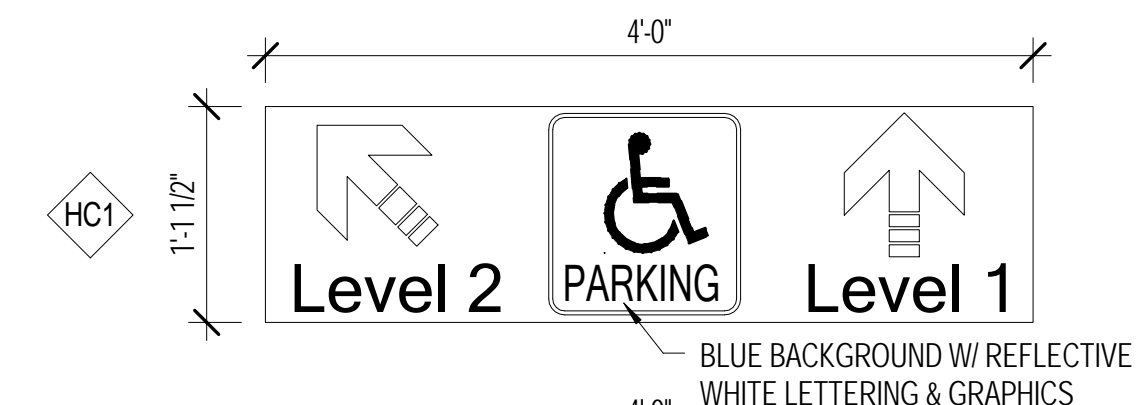
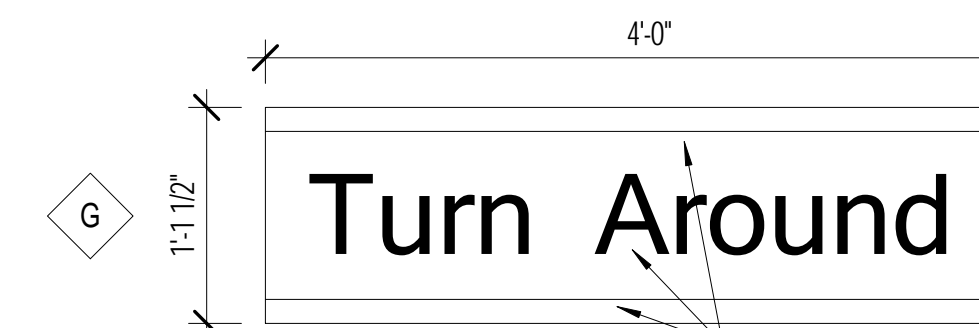
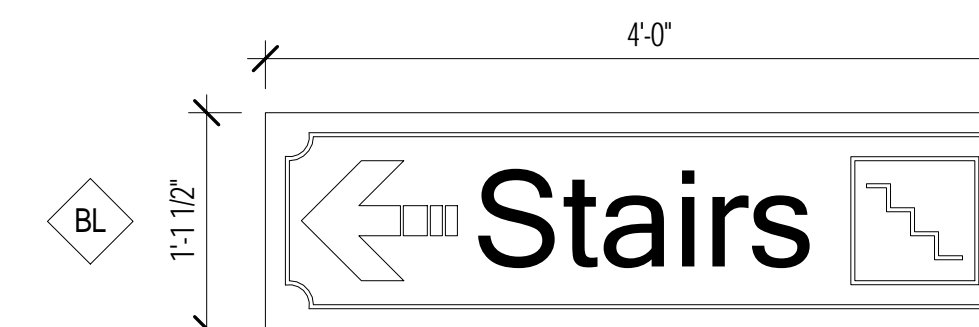
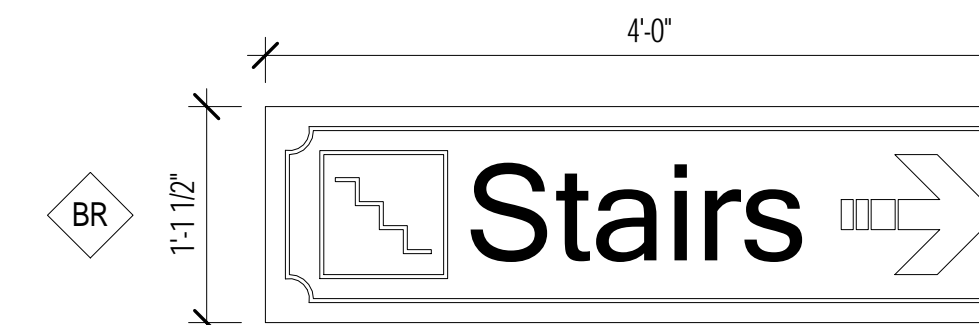
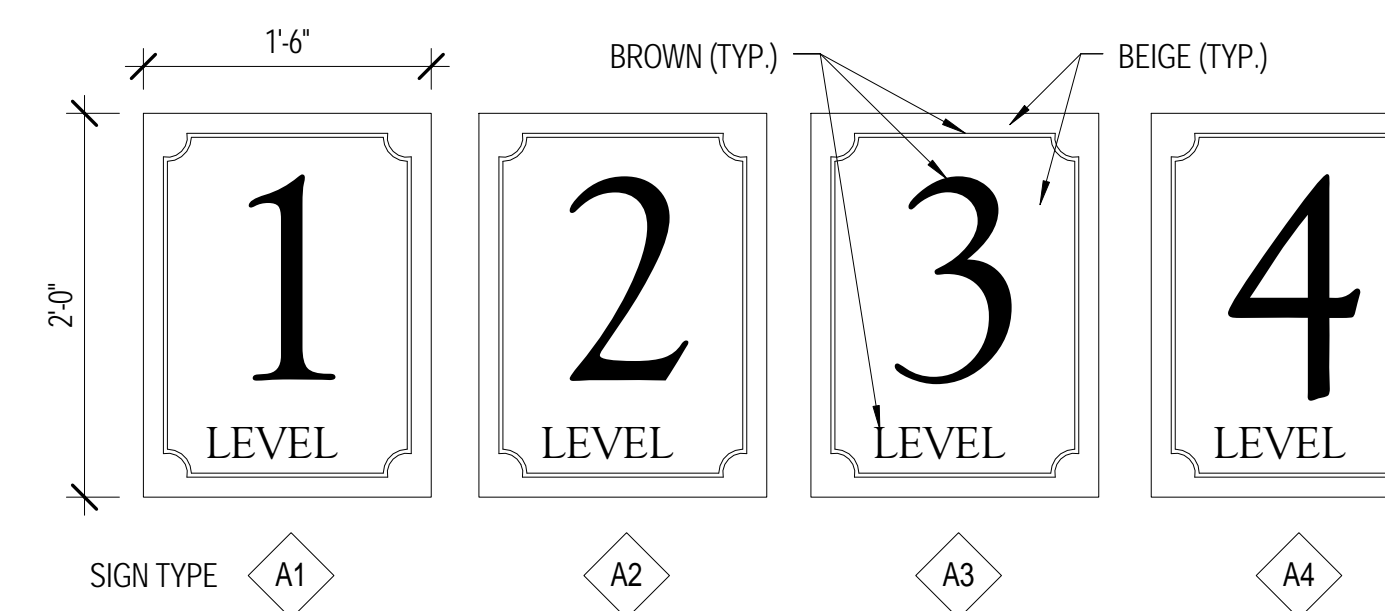
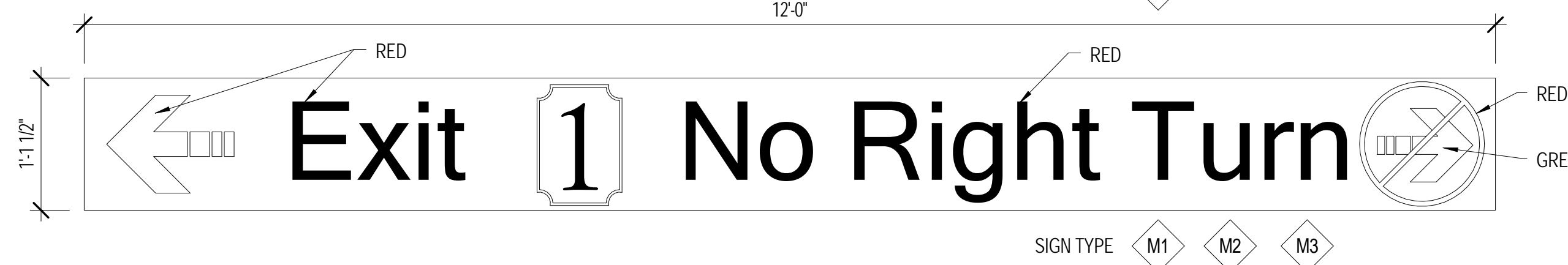
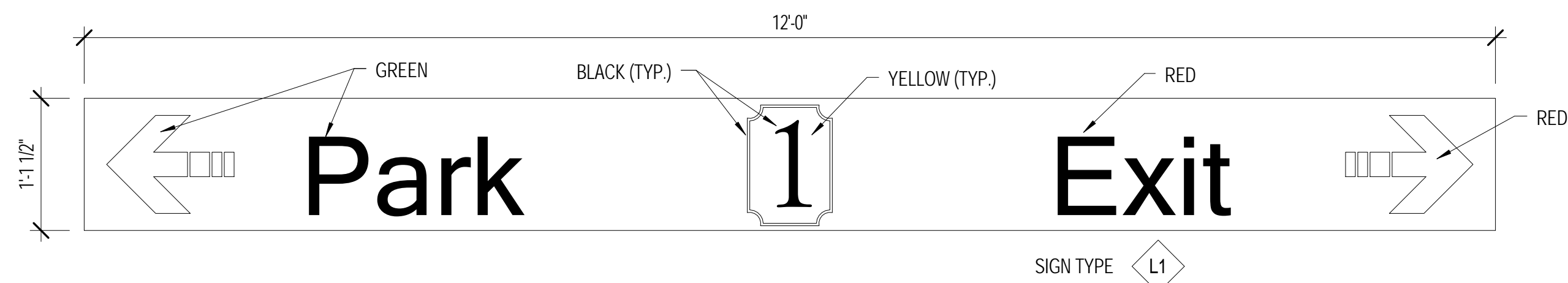
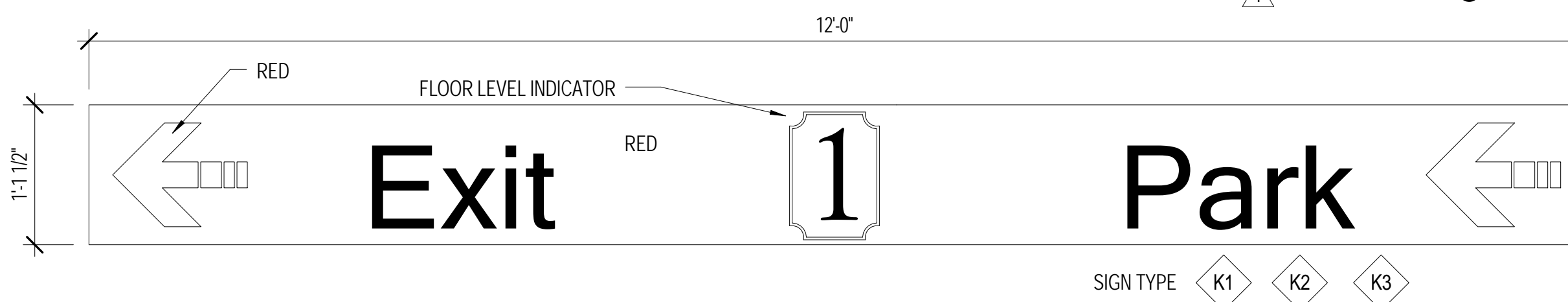
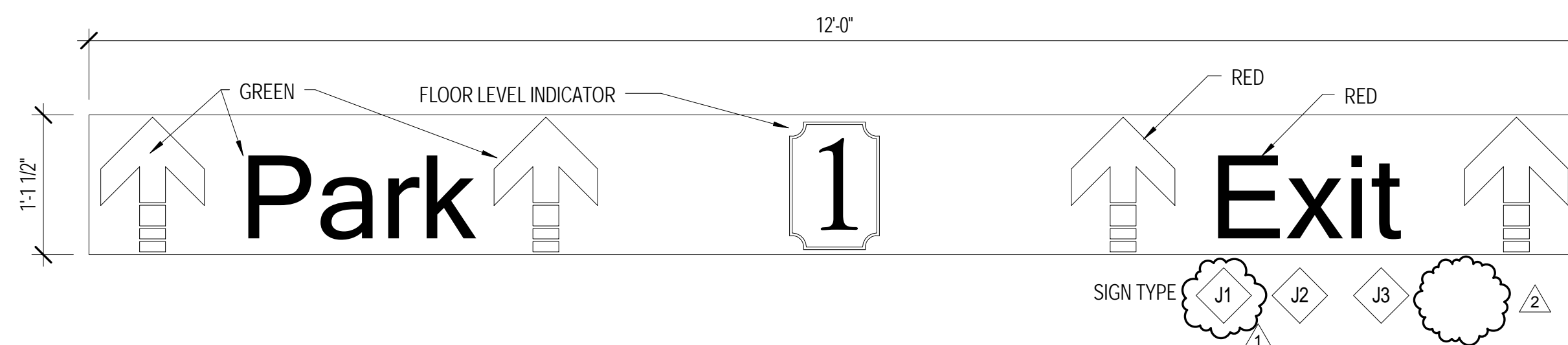
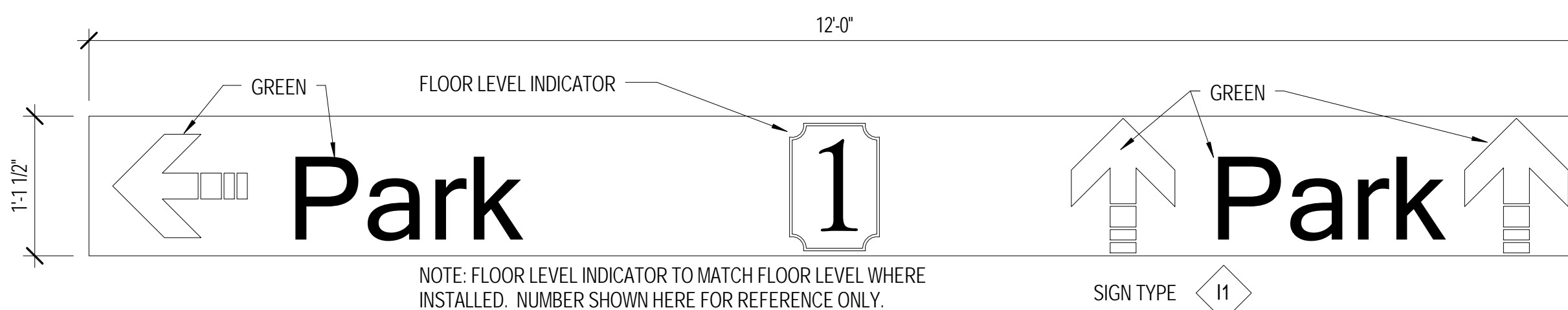
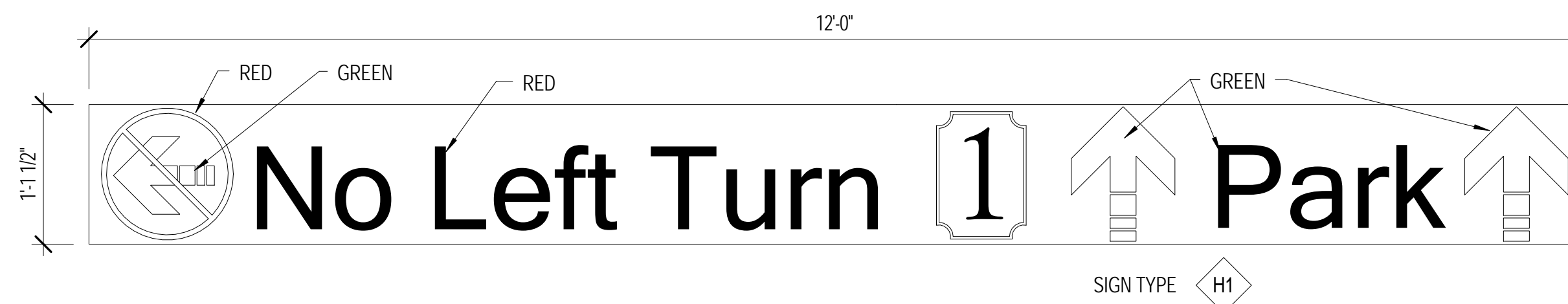
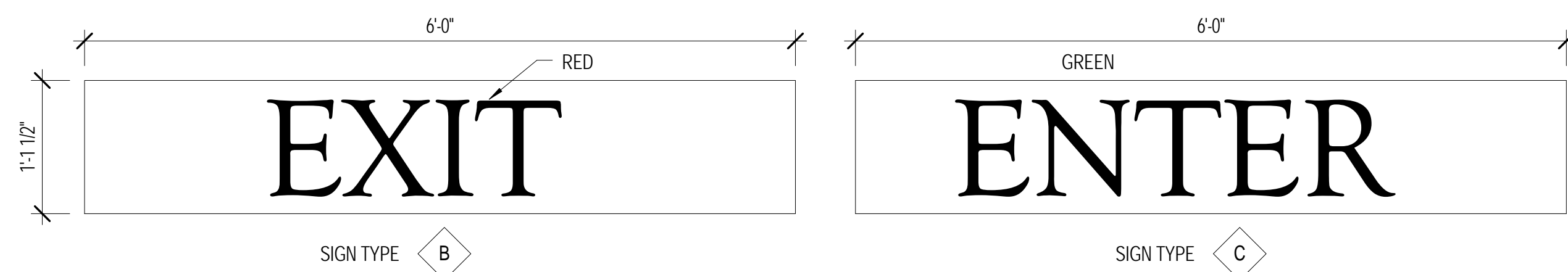

NOTES:  
1) FLOOR LEVEL INDICATOR TO MATCH FLOOR LEVEL WHERE INSTALLED. NUMBER SHOWN HERE FOR REFERENCE ONLY.

2) SEE ALSO CIVIL/SITE DRAWINGS FOR TRADITIONAL TRAFFIC SIGNAGE TYPES AND DETAILS.

3) SEE SIGNAGE PLAN DRAWINGS FOR SIGN LOCATIONS AND ADDITIONAL NOTES.

4) TEXT, ARROWS & SYMBOLS TO BE PROVIDED IN SOLID INFILLED COLORS. BACKGROUND COLOR TO BE WHITE UNLESS NOTED OTHERWISE. SUBMIT COLOR SAMPLES FOR REVIEW PRIOR TO FABRICATION.

5) "EXIT" TEXT AND ASSOCIATED ARROWS ARE TO BE RED. "PARK" TEXT AND ASSOCIATED ARROWS ARE TO BE GREEN.

6) SIGNS ON SHEET AA-705 & AA-706, EXCEPT SIGN TYPES E1 & E2, ARE PANEL SIGNS PER SPECIFICATION SECTION 101423.

**TranSystems**  
4500 SALISBURY ROAD  
SUITE 440  
JACKSONVILLE, FLORIDA 32216  
TEL: 904-680-6800  
FAX: 904-645-6670

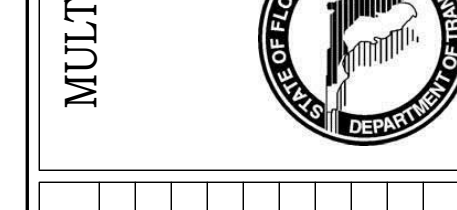
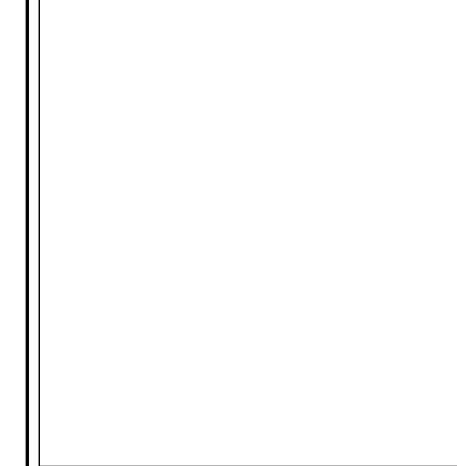
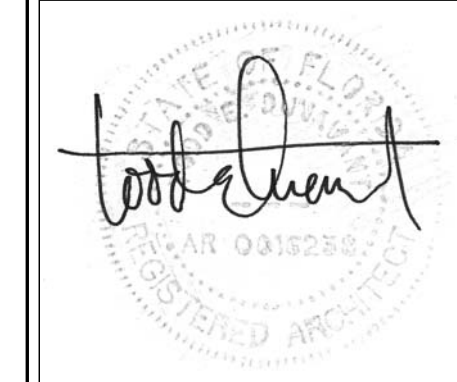

REVISIONS:	DATE	DESCRIPTION

MARK	DATE	DESCRIPTION

DRC NO:	
SCALE:	AS SHOWN
DATE:	MAY 15, 2015
DESIGNED BY:	TED
DRAWN BY:	MDB
CHECKED BY:	TED

SHEET TITLE:  
**SIGNAGE DETAILS**

SHEET NO.  
**AA-705**

SHEET OF





**TranSystems**  
 4500 SALISBURY ROAD  
 SUITE 440  
 JACKSONVILLE, FLORIDA 32216  
 PHONE: 904-245-6500  
 FAX: 904-245-6510

**MITESH K. SMART**  
 LICENSE No. 52772  
 STATE OF FLORIDA  
 PROFESSIONAL ENGINEER  
 05/16/15  
 Mitesh Smart, P.E. 92772 (FL)

**MILAN ENGINEERING**  
 925 S. Seminole Blvd Suite 1001  
 Winter Park, FL 32789  
 Certificate of Authorization #28271  
 Provide Solutions with Prompt Response

**MULTI-MODAL TRANSPORTATION FACILITY (PARKING GARAGE)**  
 CITY OF KISSIMMEE, FLORIDA  
 FDOT DISTRICT FIVE  
 OSCEOLA COUNTY  
 FOOT FINANCIAL ID NO. 433874-1-52-01

FILE NAME: P:\2013 Projects\MISC\13-561 - Kissimmee Parking Garage\WPC ELECTRICAL-GENERAL.dwg LAYOUT NAME: AE-200 PLOTTED: Friday, July 31, 2015 - 11:40am USER: presthi

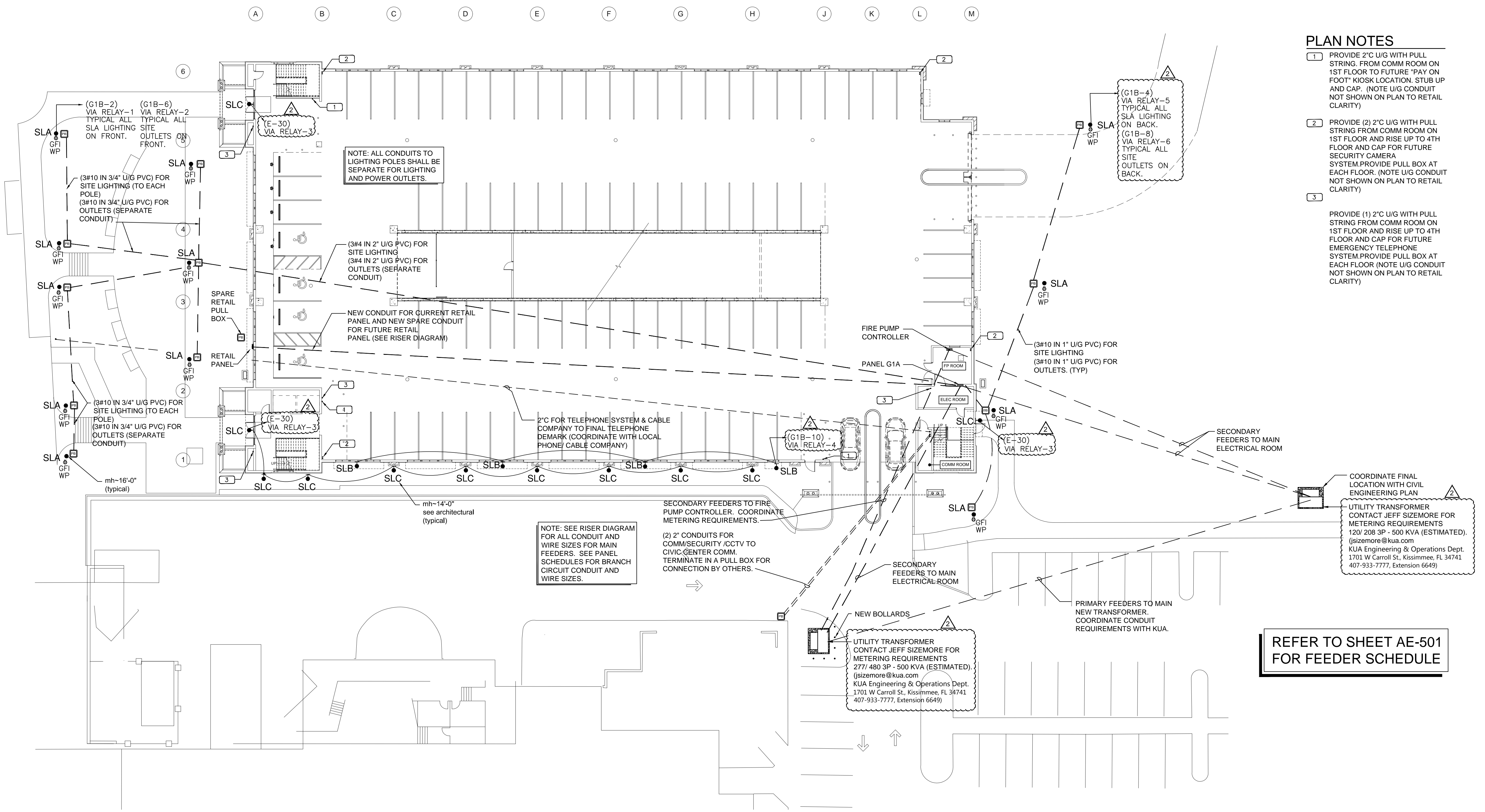

**PLAN NOTES**

- 1 PROVIDE 2" U/G WITH PULL STRING FROM COMM ROOM ON 1ST FLOOR TO FUTURE "PAY ON FOOT" KIOSK LOCATION. STUB UP AND CAP. (NOTE U/G CONDUIT NOT SHOWN ON PLAN TO RETAIL CLARITY)
- 2 PROVIDE (2) 2" U/G WITH PULL STRING FROM COMM ROOM ON 1ST FLOOR AND RISE UP TO 4TH FLOOR AND CAP FOR FUTURE SECURITY CAMERA SYSTEM. PROVIDE PULL BOX AT EACH FLOOR. (NOTE U/G CONDUIT NOT SHOWN ON PLAN TO RETAIL CLARITY)
- 3 PROVIDE (1) 2" U/G WITH PULL STRING FROM COMM ROOM ON 1ST FLOOR AND RISE UP TO 4TH FLOOR AND CAP FOR FUTURE EMERGENCY TELEPHONE SYSTEM. PROVIDE PULL BOX AT EACH FLOOR (NOTE U/G CONDUIT NOT SHOWN ON PLAN TO RETAIL CLARITY)

**REFER TO SHEET AE-501 FOR FEEDER SCHEDULE**

**1 ELECTRICAL SITE PLAN**

0 10' 20' 40' 60'  
 1" = 20'-0"

PROJECT NORTH TRUE NORTH

REVISIONS:

MARK	DATE	DESCRIPTION
Δ	08/03/2015	BIDDING ADDENDUM 01

DRC NO:  
 SCALE: AS NOTED  
 DATE: MAY 15, 2015  
 DESIGNED BY: MKS, PK, DL  
 DRAWN BY: PK, DL, SE  
 CHECKED BY: MKS

SHEET TITLE:  
**ELECTRICAL SITE PLAN**

SHEET NO.  
**AE-200**  
 SHEET X OF XX



FILE NAME: P:\2013 Projects\MISC\13-361 - Kissimmee Parking Garage\MPC ELECTRICAL.dwg LAYOUT NAME: AE-201 PLOTTED: Friday, July 31, 2015 - 11:42am USER: preethi

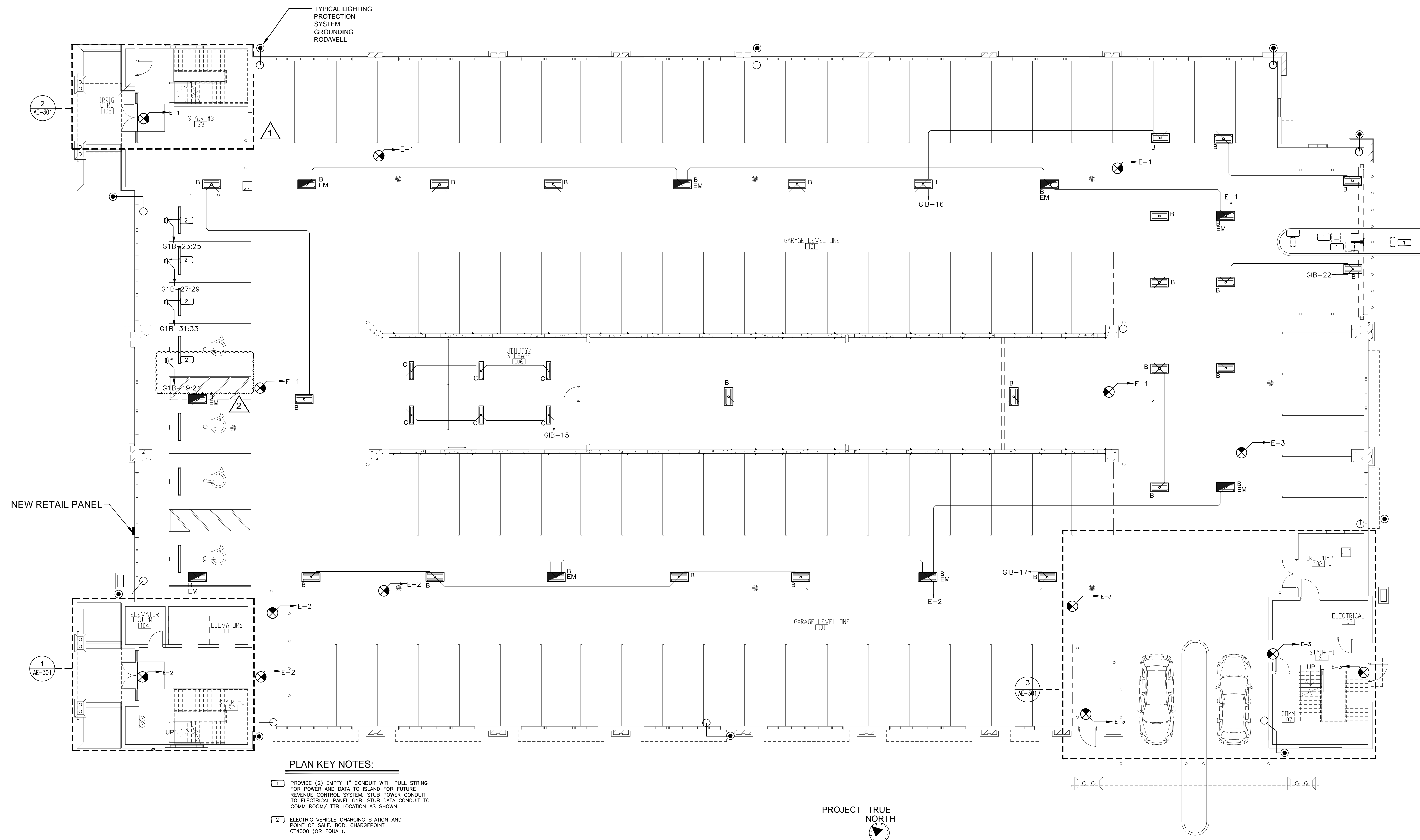

**PLAN KEY NOTES:**

- 1 PROVIDE (2) EMPTY 1" CONDUIT WITH PULL STRING FOR POWER AND DATA TO ISLAND FOR FUTURE REVENUE CONTROL SYSTEM. STUB POWER CONDUIT TO ELECTRICAL PANEL GIB. STUB DATA CONDUIT TO COMM ROOM/ TTB LOCATION AS SHOWN.
- 2 ELECTRIC VEHICLE CHARGING STATION AND POINT OF SALE. BOD: CHARGEPOINT CT4000 (OR EQUAL).

PROJECT TRUE NORTH

REFER TO SHEET AE-101 FOR PLAN NOTES

**TranSystems**  
 4500 SALISBURY ROAD  
 SUITE 440  
 JACKSONVILLE, FLORIDA 32216  
 PHONE: 904-245-6500  
 FAX: 904-245-6510

MITESH K. SMART  
 LICENSE No. 52772  
 STATE OF FLORIDA  
 PROFESSIONAL ENGINEER  
 05/15/15 PE 52772 (FL)  
 Mitesh Smart, Inc.

**MILAN ENGINEERING**  
 925 S. Semoran Blvd | Suite 1001  
 Winter Park, FL 32782  
 Certificate of Authorization #28271  
 Provide Solutions with Prompt Response

MULTI-MODAL TRANSPORTATION FACILITY  
 (PARKING GARAGE)  
 CITY OF KISSIMMEE, FLORIDA

FDOT DISTRICT FIVE  
 OSCEOLA COUNTY  
 FOOT FINANCIAL ID NO. 483874-1-58-01

FLORIDA DEPARTMENT OF TRANSPORTATION

REVISIONS:

MARK	DATE	DESCRIPTION
1	08/03/2015	BIDDING ADDENDUM 01
2	05/15/2015	COOK REVIEW COMMENTS

DRC NO:  
 SCALE: AS NOTED  
 DATE: MAY 15, 2015  
 DESIGNED BY: MKS,PK,DL  
 DRAWN BY: PK,DL,SE  
 CHECKED BY: MKS

SHEET TITLE:  
**LEVEL ONE OVERALL ELECTRICAL PLAN**

SHEET NO.  
**AE-201**  
 SHEET X OF XX

FILE NAME: P:\2013 Projects\MISC\13-361 - Kissimmee Parking Garage\MFC ELECTRICAL.dwg LAYOUT NAME: AE-204 PLOTTED: Friday, July 31, 2015 - 11:43am USER: preethi

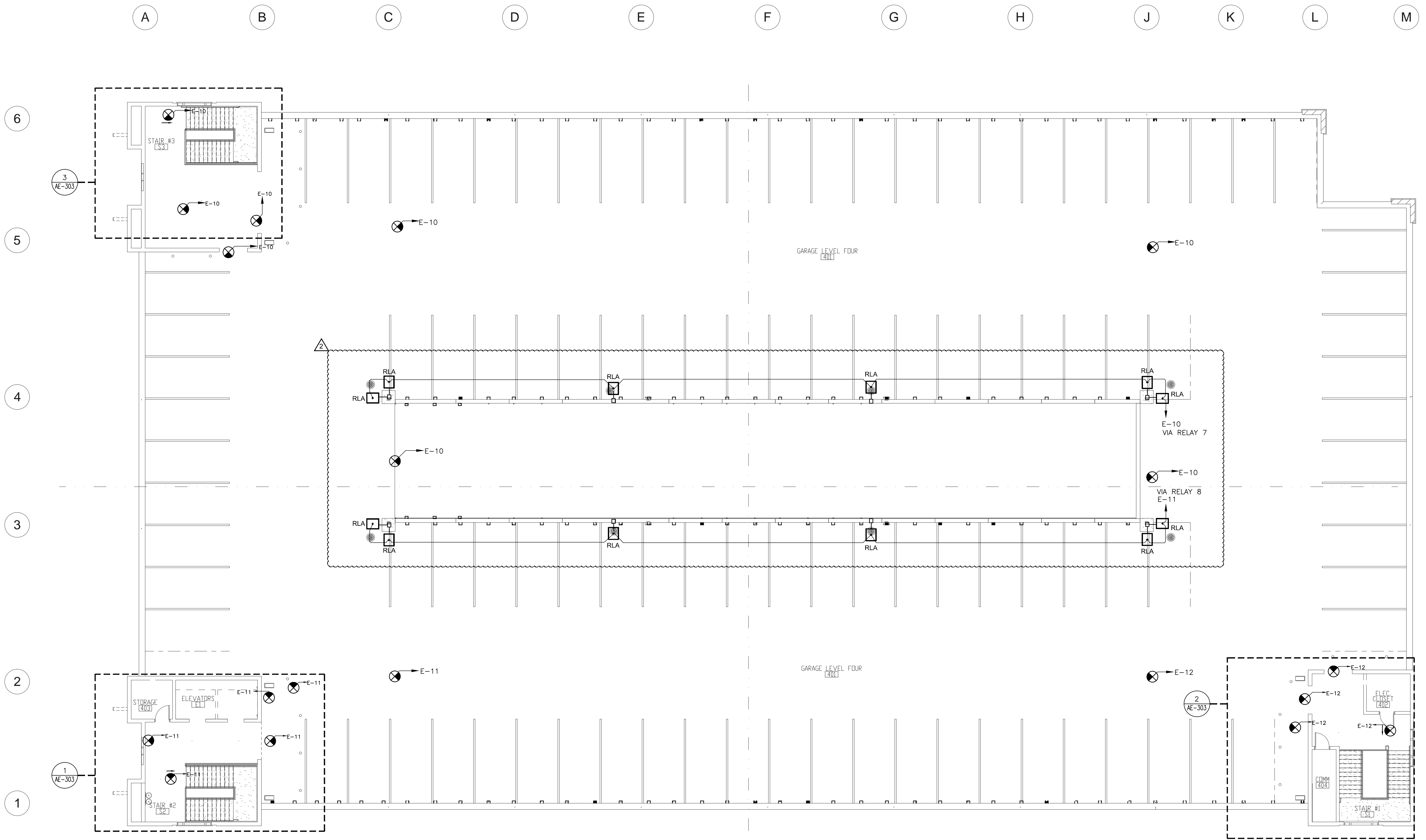

1 LEVEL FOUR OVERALL ELECTRICAL PLAN

0 16' 32' 64' 96'

1/32" = 1'-0"

PROJECT NORTH

TRUE NORTH

**TranSystems**

4500 SALISBURY ROAD  
SUITE 440  
JACKSONVILLE, FLORIDA 32216  
PHONE: 904-245-6500  
FAX: 904-245-6510

MITESH K. SMART  
LICENSED PROFESSIONAL ENGINEER  
No. 52772  
STATE OF FLORIDA  
05/16/15  
Mitesh Smart, P.E. 52772 (FL)

**MILAN ENGINEERING**

925 S Semoran Blvd | Suite 1001  
Winter Park, FL 32789  
Certificate of Authorization #28271  
Provide Solutions with Prompt Response

MULTI-MODAL TRANSPORTATION FACILITY  
(PARKING GARAGE)  
CITY OF KISSIMMEE, FLORIDA

FDOT DISTRICT FIVE  
OSCEOLA COUNTY  
FOOT FINANCIAL ID NO: 433874-1-52-01

REVISIONS:	MARK	DATE	DESCRIPTION

DRC NO:

SCALE: AS NOTED

DATE: MAY 15, 2015

DESIGNED BY: MKS,PK,DL

DRAWN BY: PK,DL,SE

CHECKED BY: MKS

SHEET TITLE:

**LEVEL FOUR OVERALL ELECTRICAL PLAN**

SHEET NO.

**AE-204**

SHEET X OF XX

FILE NAME: P:\2013 Projects\MISC\13-261 - Kissimmee Parking Garage\ELECTRICAL-GENERAL.dwg LAYOUT NAME: AE-501 PLOTTED: Friday, July 31, 2015 - 11:41am USER: preehr

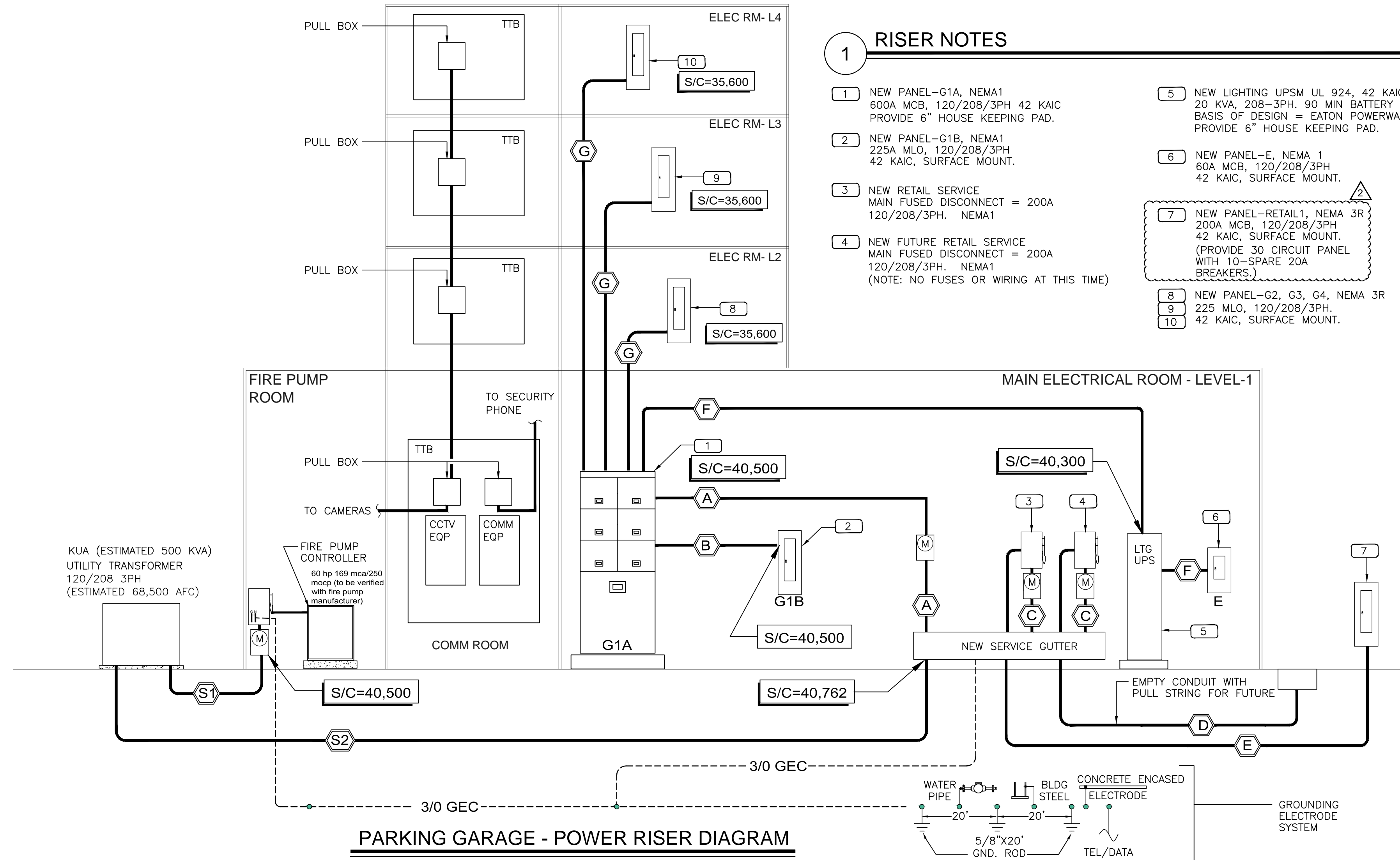

### 1 RISER NOTES

- 1 NEW PANEL-G1A, NEMA1 600A MCB, 120/208/3PH 42 KAIC PROVIDE 6" HOUSE KEEPING PAD.
- 2 NEW PANEL-G1B, NEMA1 225A MLO, 120/208/3PH 42 KAIC, SURFACE MOUNT.
- 3 NEW RETAIL SERVICE MAIN FUSED DISCONNECT = 200A 120/208/3PH. NEMA1
- 4 NEW FUTURE RETAIL SERVICE MAIN FUSED DISCONNECT = 200A 120/208/3PH. NEMA1 (NOTE: NO FUSES OR WIRING AT THIS TIME)
- 5 NEW LIGHTING UPSM UL 924, 42 KAIC 20 KVA, 208-3PH. 90 MIN BATTERY BASIS OF DESIGN = EATON POWERWARE. PROVIDE 6" HOUSE KEEPING PAD.
- 6 NEW PANEL-E, NEMA 1 60A MCB, 120/208/3PH 42 KAIC, SURFACE MOUNT.
- 7 NEW PANEL-RETAIL1, NEMA 3R 200A MCB, 120/208/3PH 42 KAIC, SURFACE MOUNT. (PROVIDE 30 CIRCUIT PANEL WITH 10-SPARE 20A BREAKERS.)
- 8 NEW PANEL-G2, G3, G4, NEMA 3R 225 MLO, 120/208/3PH.
- 9 42 KAIC, SURFACE MOUNT.
- 10

**PARKING GARAGE - POWER RISER DIAGRAM**

### KISSIMMEE PARKING GARAGE - ELECTRICAL FEEDER SCHEDULE

TAG	FED FROM	TO	VOLTAGE	PHASE	AMBIENT TEMP (F)	TOTAL AMPS (DESIGN LOAD)	No. OF SETS	CONDUCTOR SIZE			WIRE	TRADE SIZE	ESTIMATED RUN LENGTH (FT)	CALCULATED VOLTAGE DROP (PF-85%)
								FEEDER CONDUCTOR (KCML OR AWG)	NEUTRAL CONDUCTOR (KCML OR AWG)	GROUND (See note 1) (KCML OR AWG)				
S1	UTILITY	FP CONTROLLER	208	3	75	250	1	250	250		Cu	4"	75	1.10%
S2	UTILITY	SERVICE TROUGH	208	3	75	1000	3	400	400	-	Cu	4"	75	1.10%
A	TROUGH	PANEL G1A	208	3	75	600	2	350	350	3/O	Cu	3"	10	~0
B	PANEL G1A	PANEL G1B	208	3	75	200	2	3/O	3/O	#6	Cu	2"	10	~0
C	TROUGH	RETAIL DISC	208	3	75	200	2	3/O	3/O	3/O	Cu	2"	10	~0
D	RETAIL DISC	PULL BOX	208	3	75	200	2	(PULL STRING FOR FUTURE)			3"			
E	RETAIL DISC	PANEL-RETAIL1	208	3	75	200	2	250	250	#3	Cu	3"	275	~0
F	PANEL G1A	LTG UPS/ PNL-E	208	3	75	60	1	#6	#6	#10	Cu	1"	10	~0
G	PANEL G1A	PANEL G2,G3,G4	208	3	75	200	2	3/O	3/O	#6	Cu	2"	30	0.50%

- Notes**
- 1. For service entrance lateral feeders, omit grounding conductors from Utility Transformer to Service Equipment and provide grounding at the service equipment location as Table 250-66. indicated in the riser diagram and as required by NEC
  - 2. All feeders have been sized for a max voltage drop of 2%, branch circuits have been sized for max voltage drop of 3%, and the system designed per FBC 13-413

**TranSystems**  
 4500 SALISBURY ROAD  
 SUITE 440  
 JACKSONVILLE, FLORIDA 32216  
 PHONE: 904-245-6500  
 FAX: 904-245-6510

**MILAN ENGINEERING**  
 925 S. Seminole Blvd | Suite 1001  
 Winter Park, FL 32789  
 Certificate of Authorization #28271  
 Provide Solutions with Prompt Response

**MITESH K. SMART**  
 LICENSE No. 52772  
 STATE OF FLORIDA  
 PROFESSIONAL ENGINEER  
 06/16/15  
 Mitesh Smart, P.E. 52772 (FL)

**MULTI-MODAL TRANSPORTATION FACILITY (PARKING GARAGE)**  
 CITY OF KISSIMMEE, FLORIDA

**FDOT DISTRICT FIVE OSCEOLA COUNTY**  
 FOOT FINANCIAL ID NO. 483874-1-52-01

**FLORIDA DEPARTMENT OF TRANSPORTATION**

REVISIONS:

NO.	DATE	DESCRIPTION
1	08/03/2015	BIDDING ADDENDUM 01

DRC NO:  
 SCALE: AS NOTED  
 DATE: MAY 15, 2015  
 DESIGNED BY: MKS,PK,DL  
 DRAWN BY: PK,DL,SE  
 CHECKED BY: MKS

SHEET TITLE:  
**ELECTRICAL POWER RISER DIAGRAM**

SHEET NO.  
**AE-501**  
 SHEET X OF XX